

Figure 3.7.2-56: Control Building SASSI2010 Solid Elements Modeling the Basemat

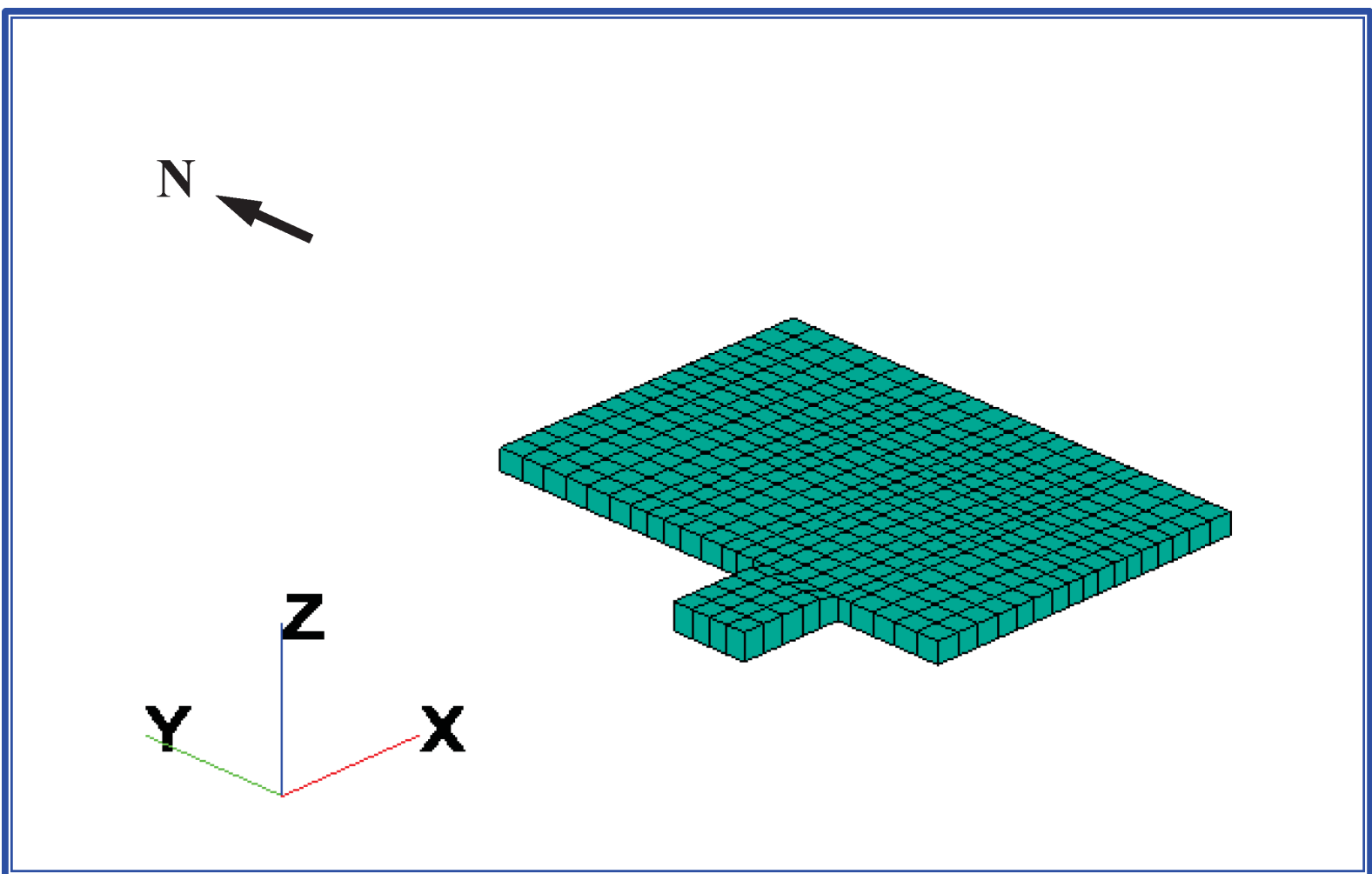


Figure 3.7.2-57: Control Building SASSI2010 Model Shell and Beam Element

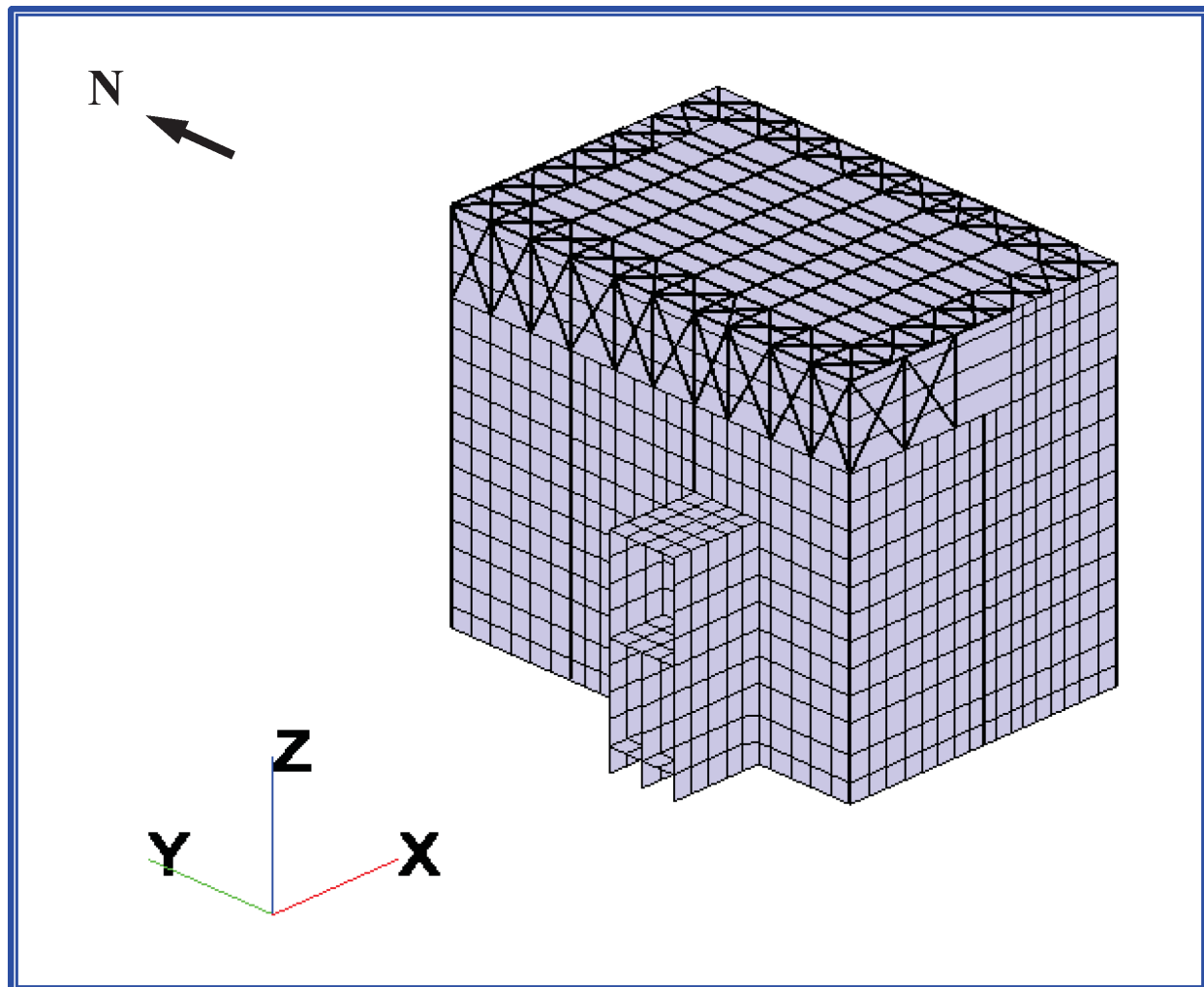




Figure 3.7.2-58: Control Building SASSI2010 Model Beam Elements

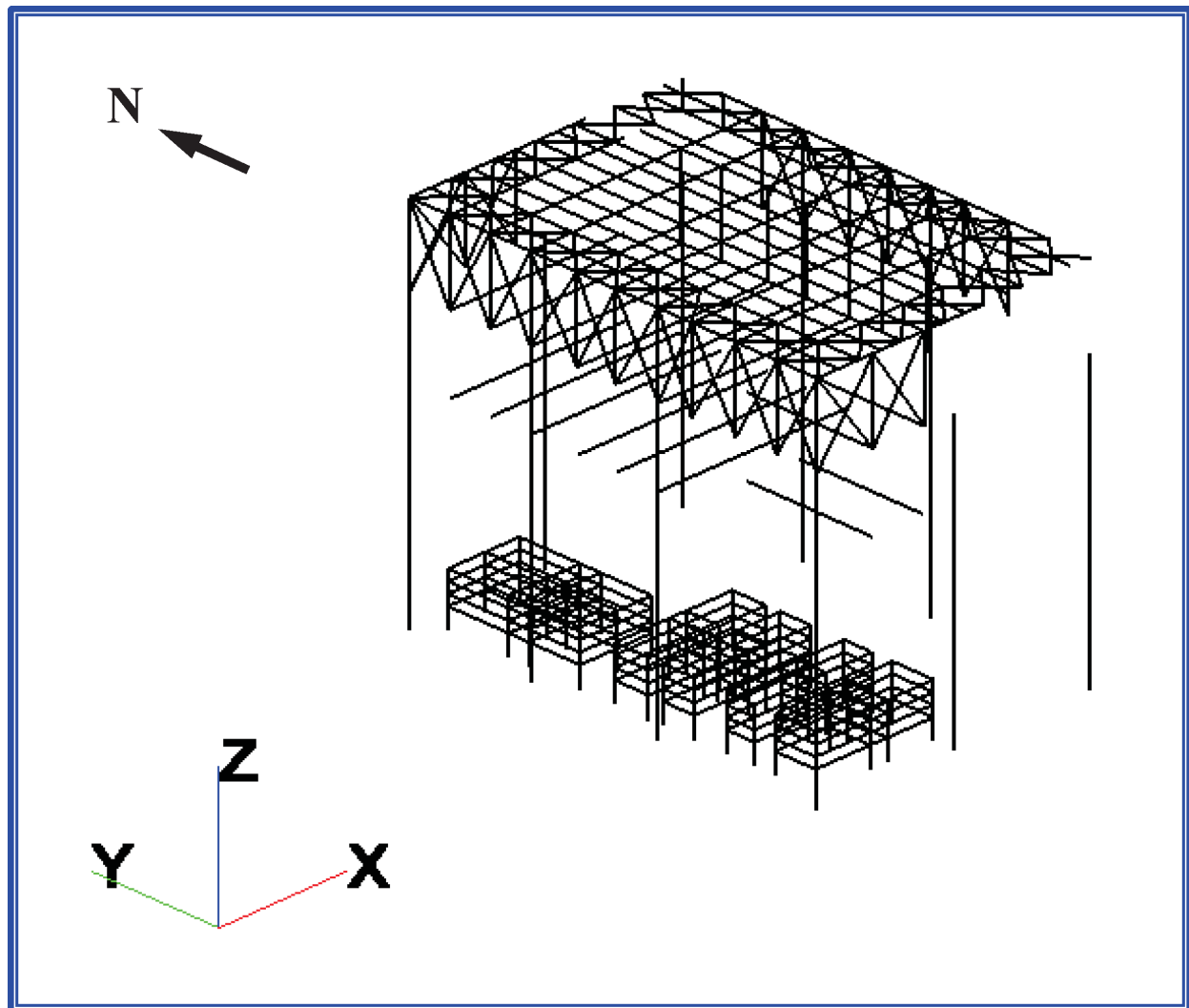


Figure 3.7.2-59: Structures and Backfill Soil of Triple Building SAP2000 Model

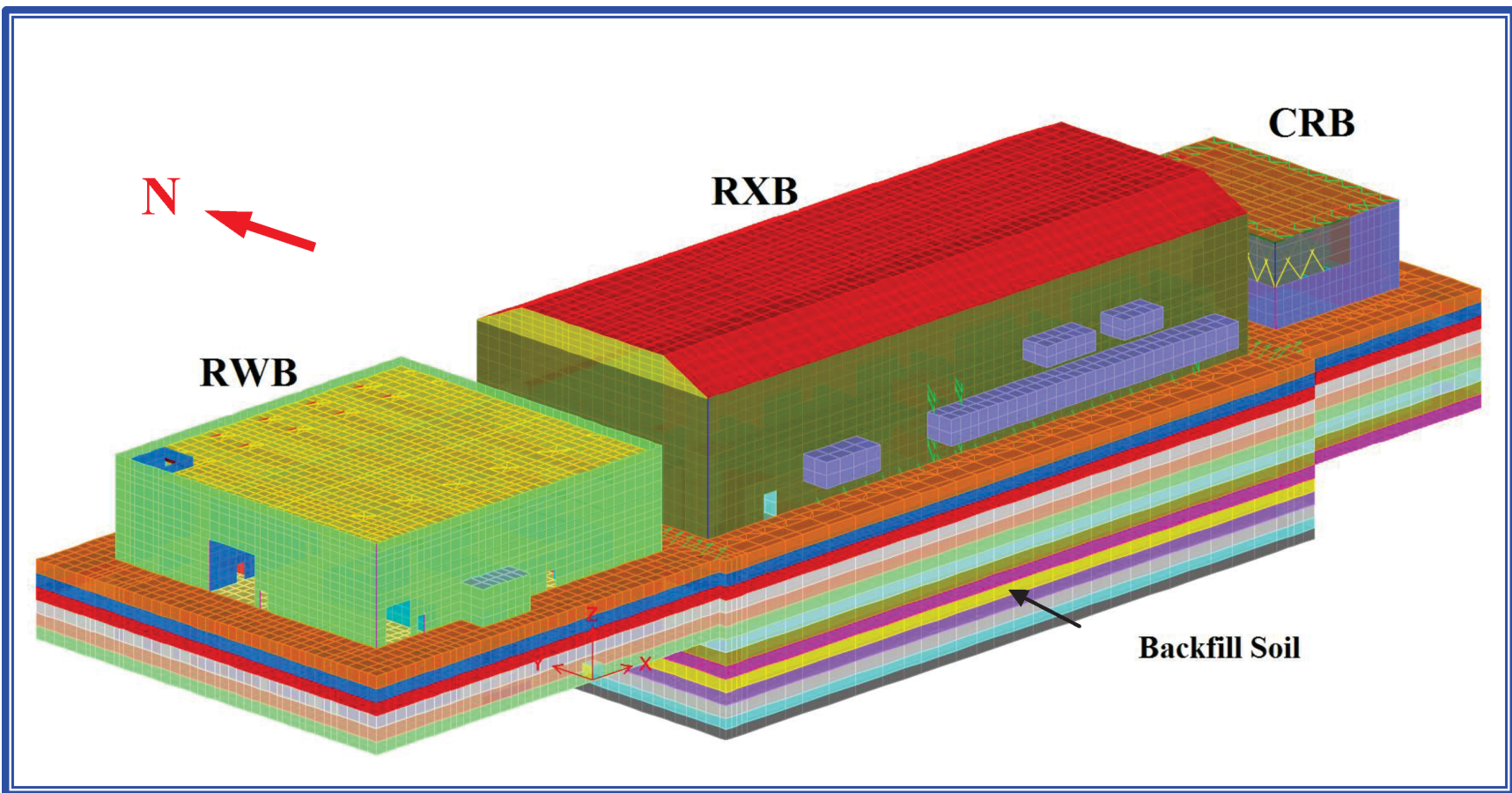


Figure 3.7.2-60: Isometric View of South Side of Triple SAP2000 Model (Looking Northeast)

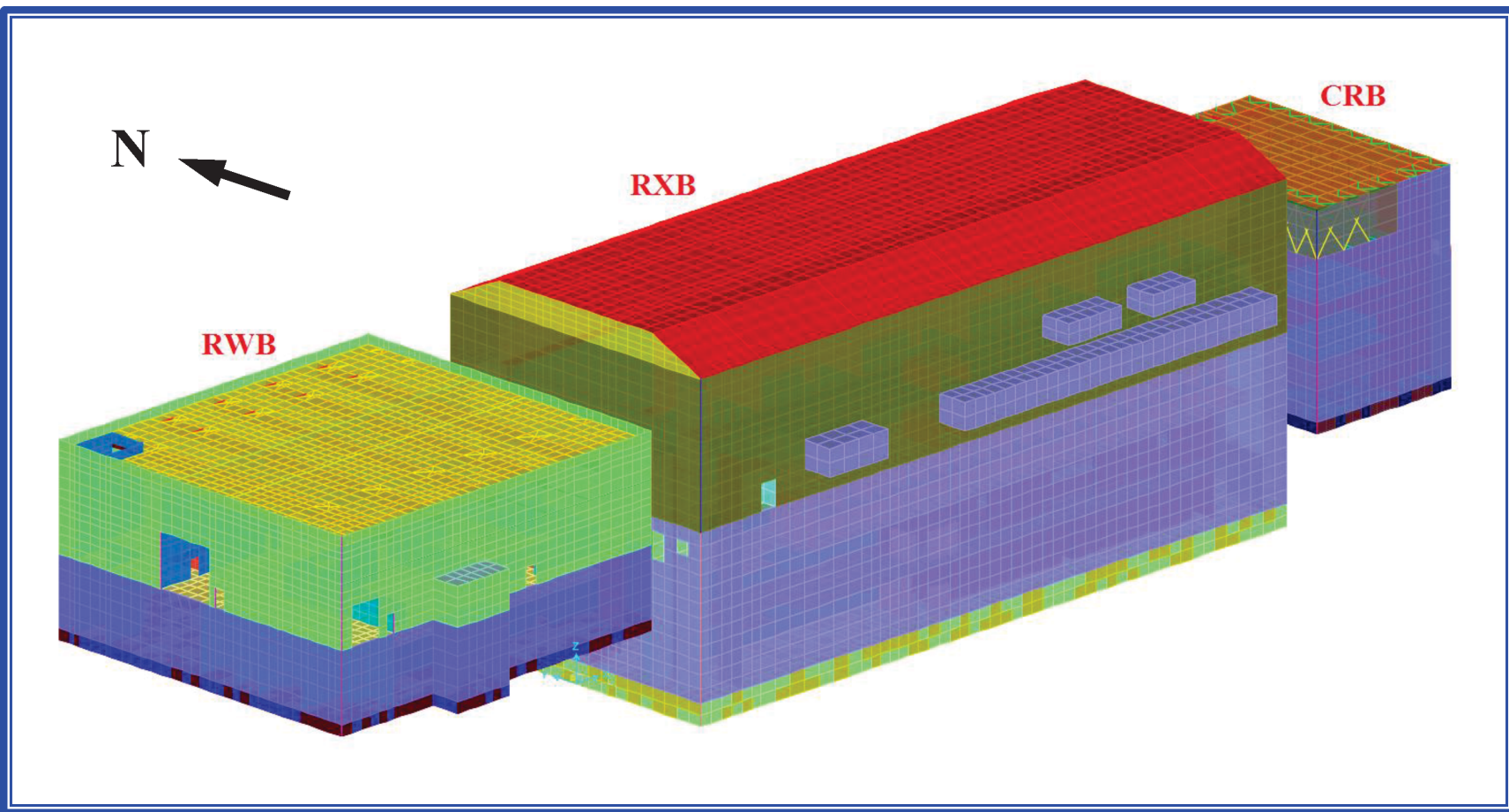


Figure 3.7.2-61: Isometric View of South Side of Triple Building SAP2000 Model (Looking Northwest)

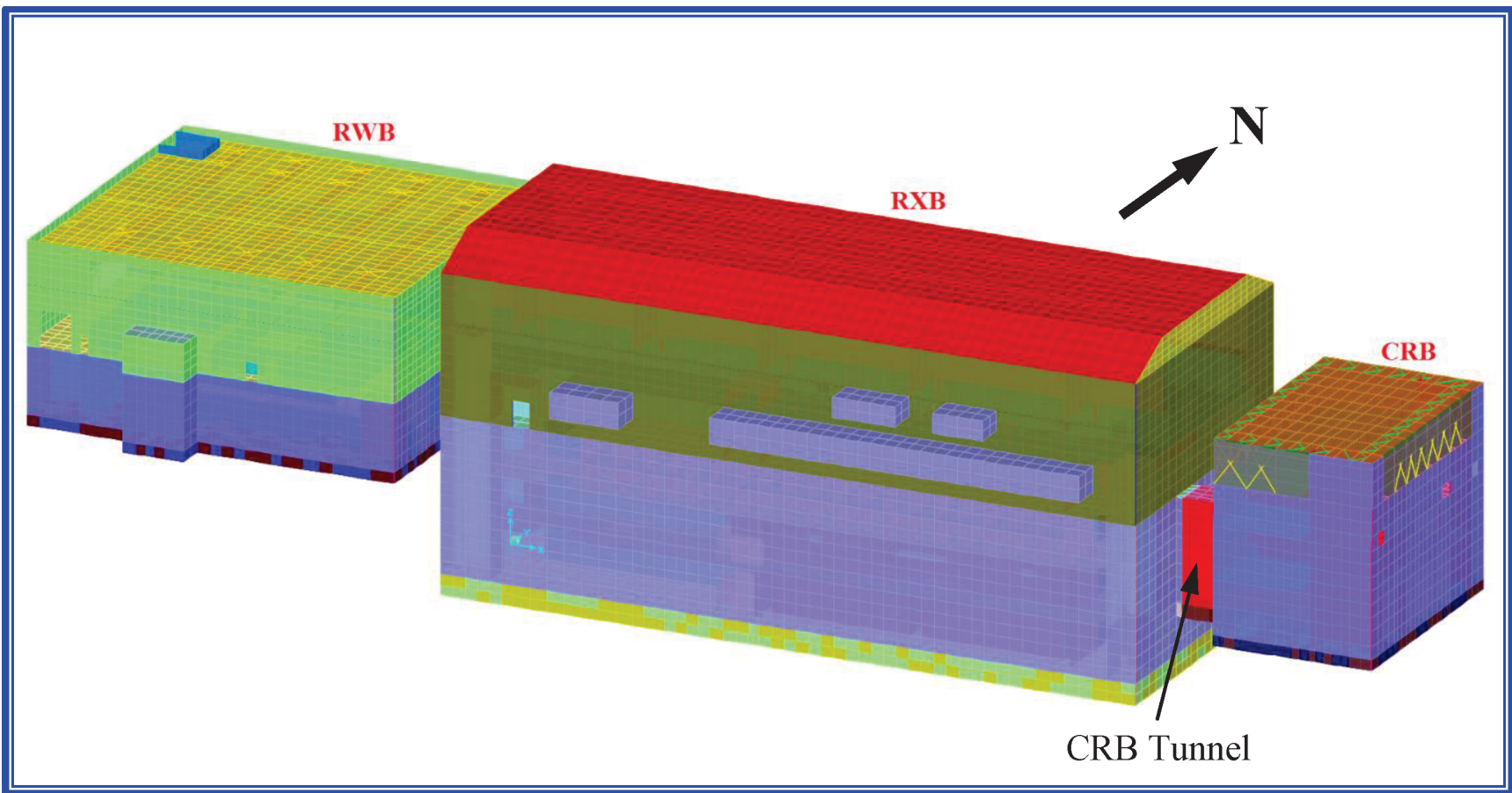




Figure 3.7.2-62: Isometric View of North Side of Triple Building SAP2000 Model (Looking Southwest)

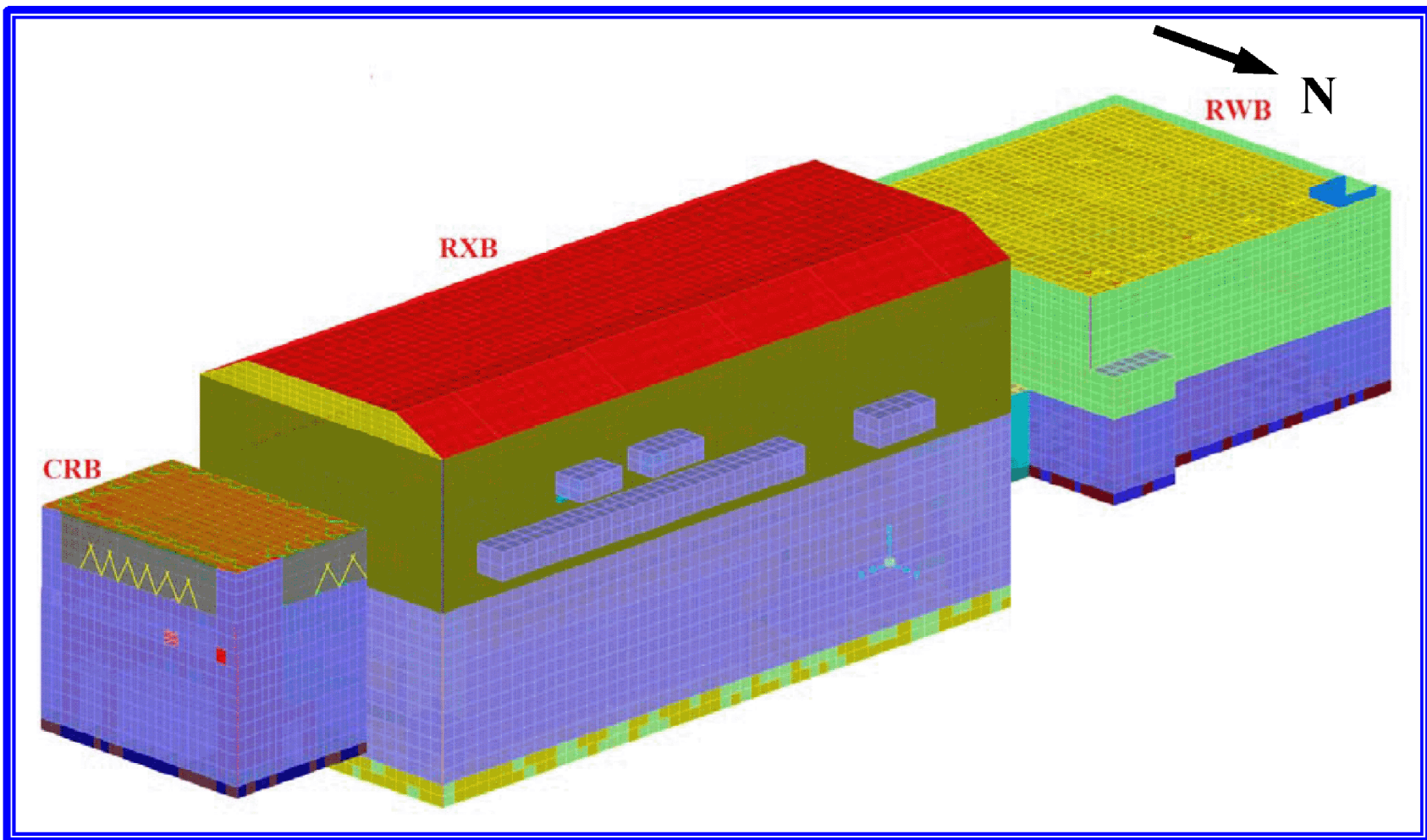


Figure 3.7.2-63: Isometric View of Backfill Soil Elements around the Three Buildings

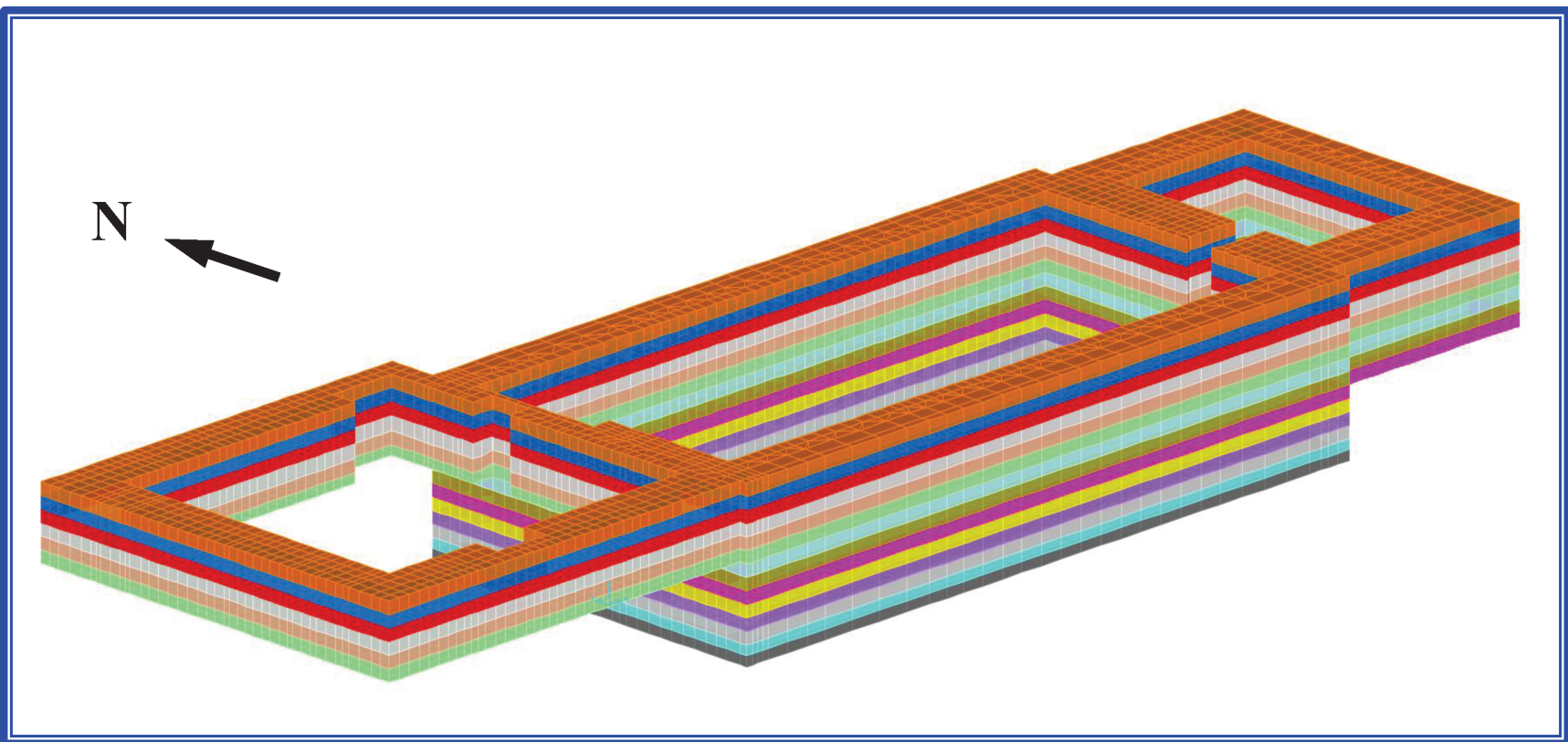


Figure 3.7.2-64: Beam Elements of Triple Building SAP2000 Model

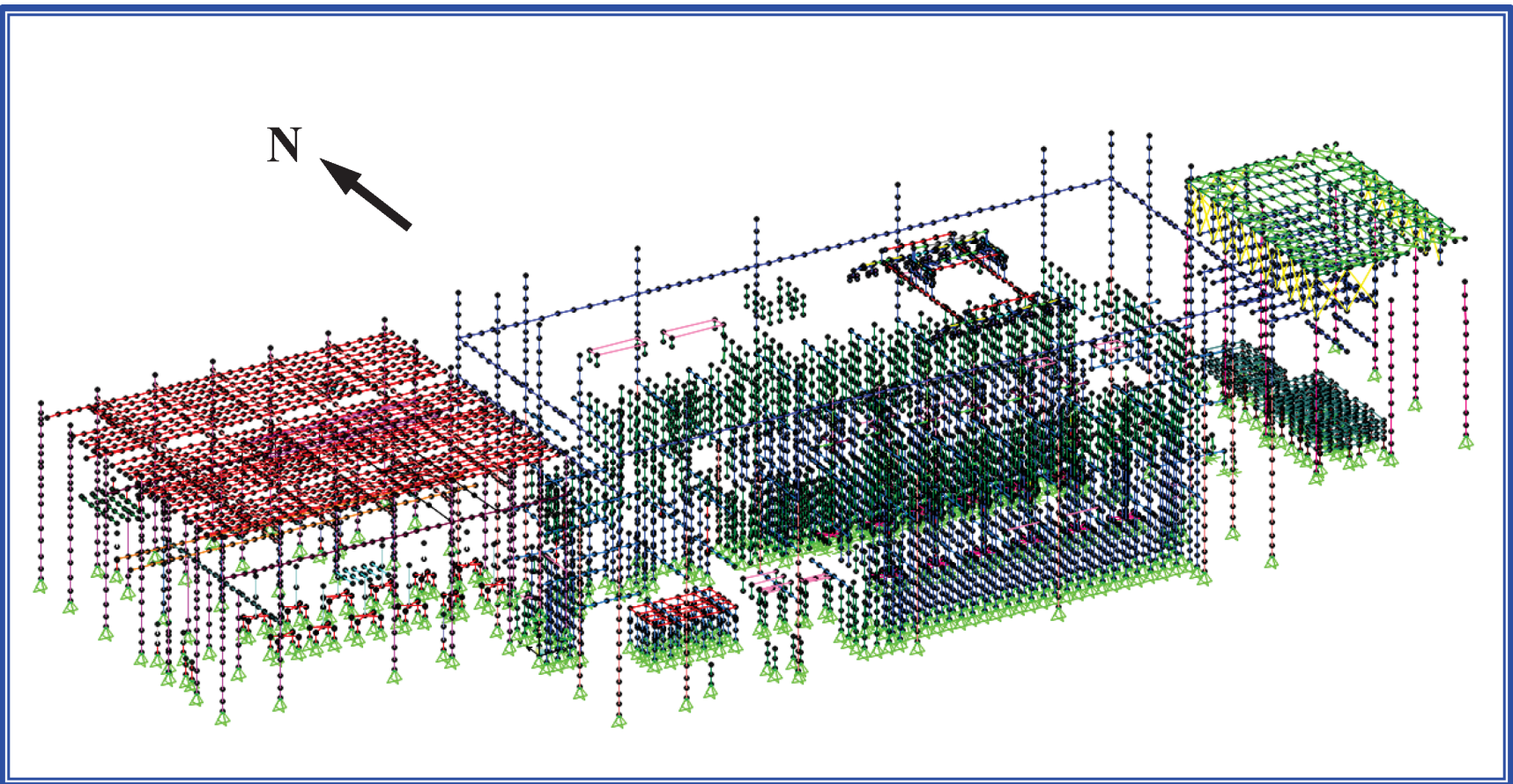




Figure 3.7.2-65: Spring or Link Elements of Triple Building SAP2000 Model

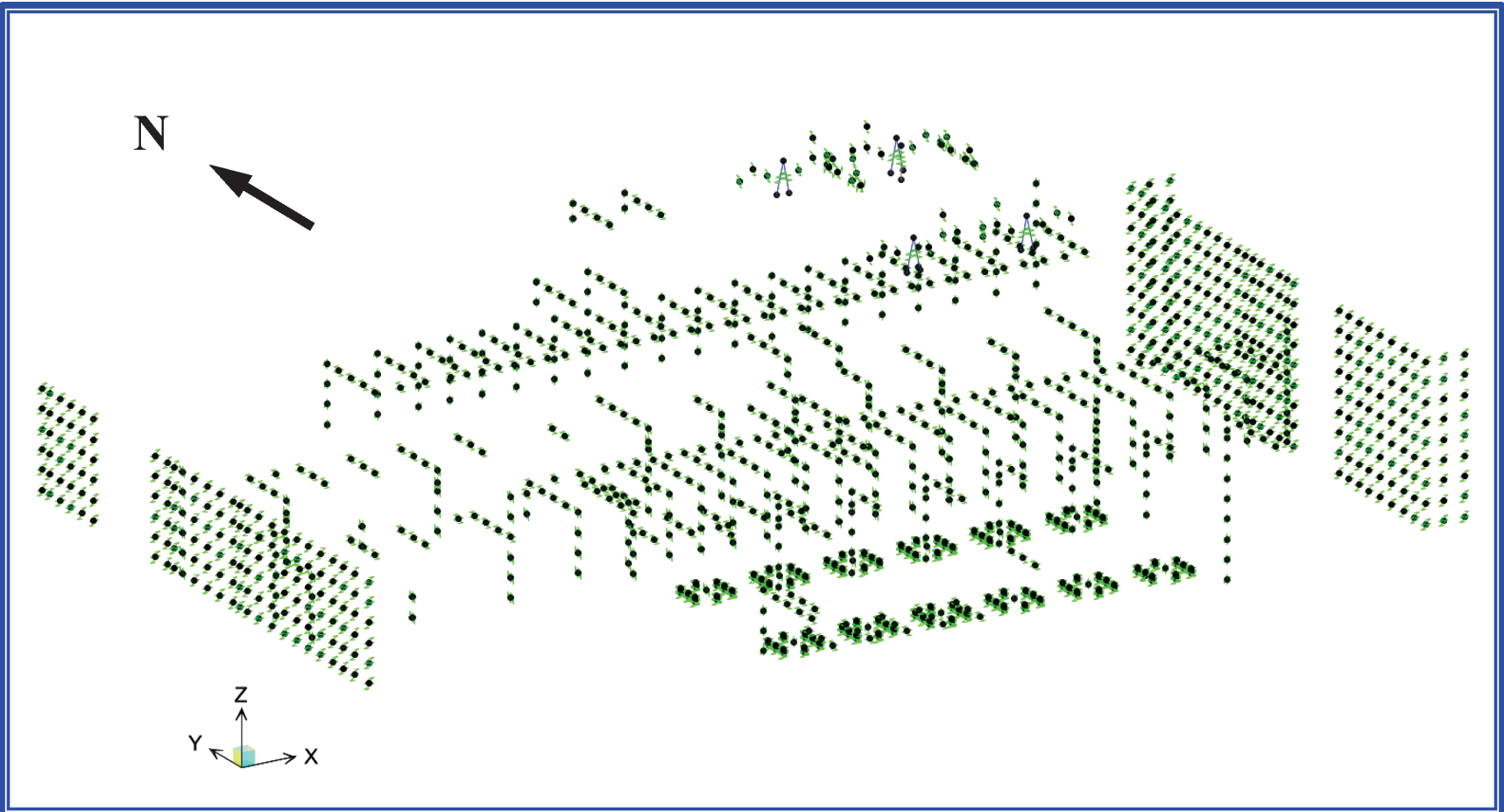




Figure 3.7.2-66: Elevation View of Triple Building SAP2000 Model Showing Separation

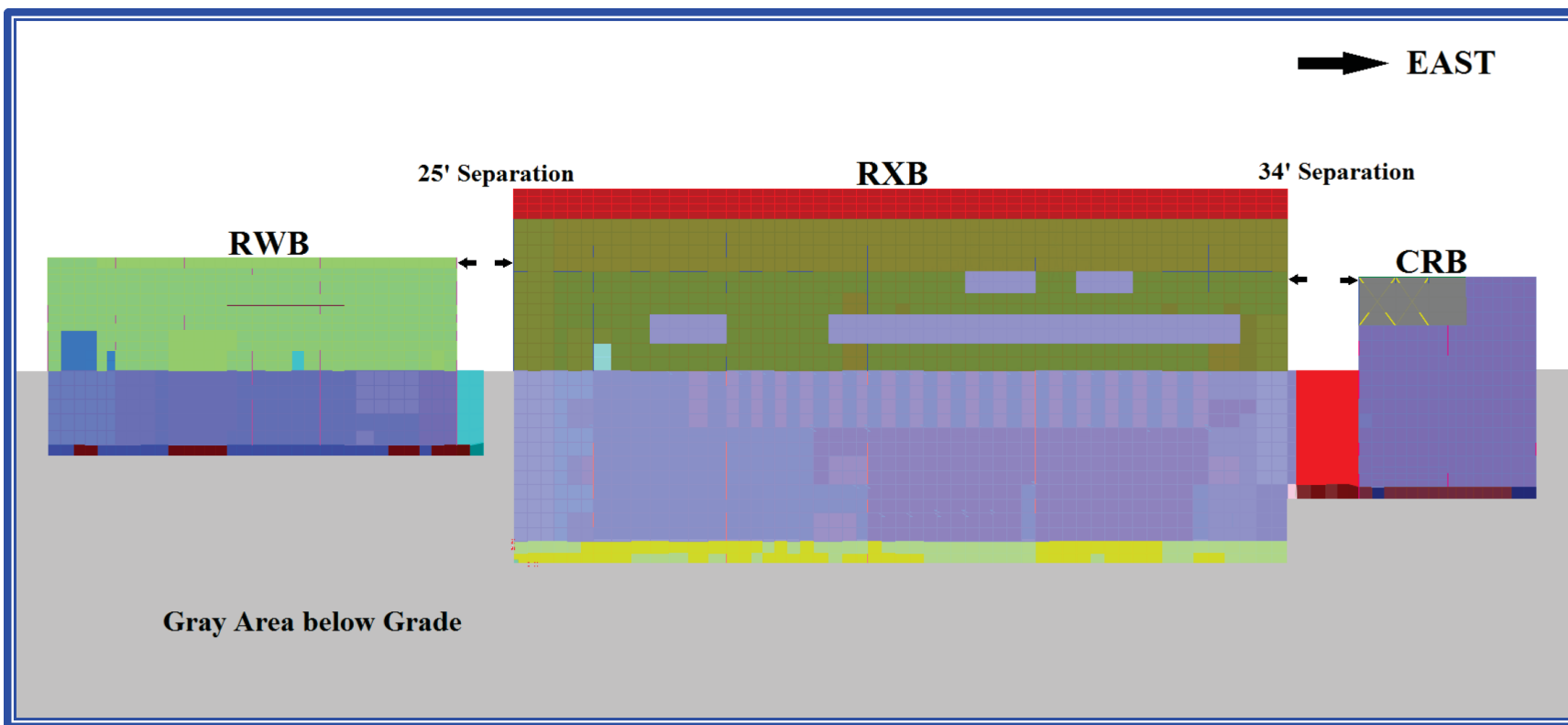


Figure 3.7.2-67: Isometric View of SASSI2010 Triple Building

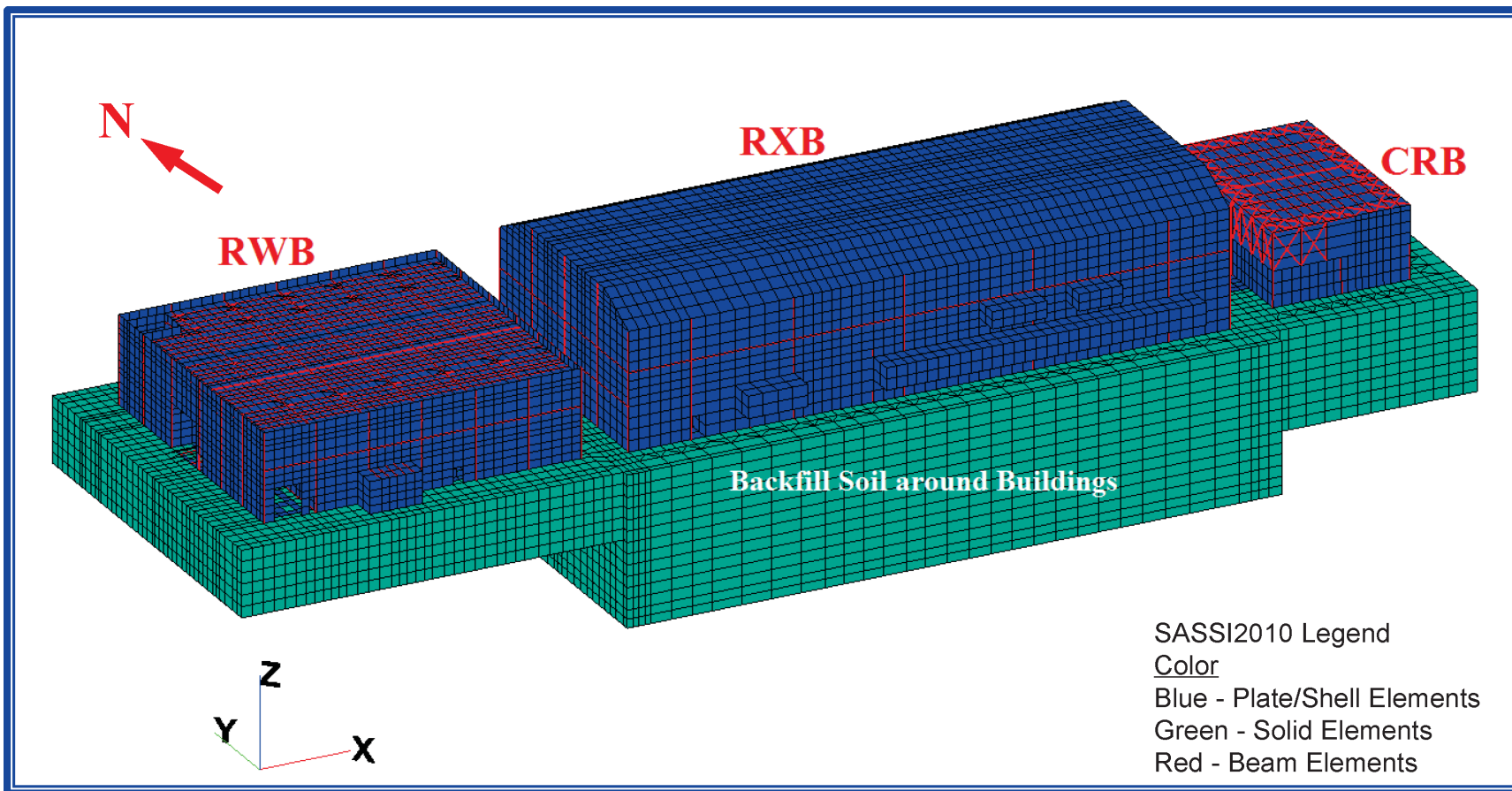


Figure 3.7.2-68: North Half View of SASSI2010 Triple Building Model

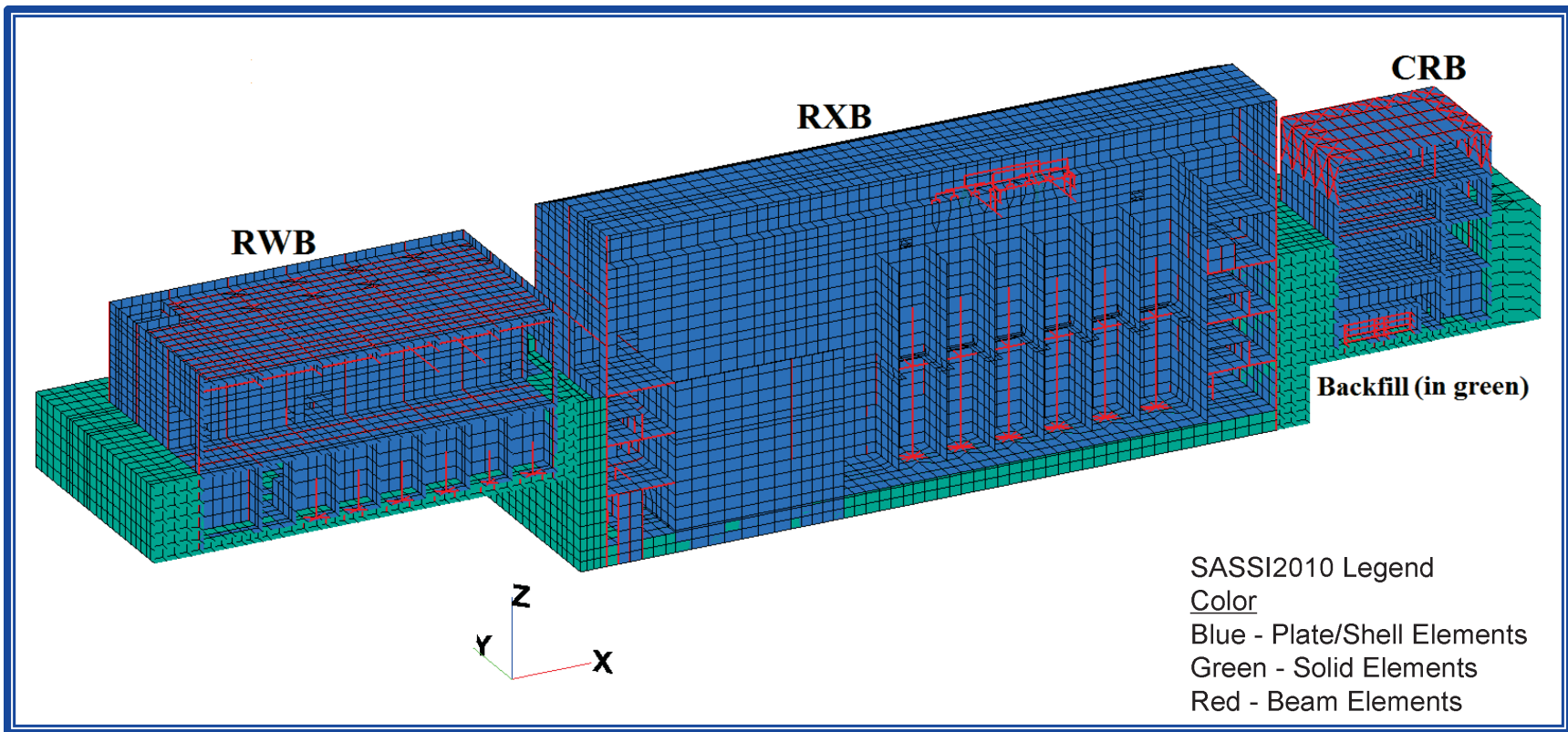


Figure 3.7.2-69: SASSI2010 Triple Building Model Shown without Backfill

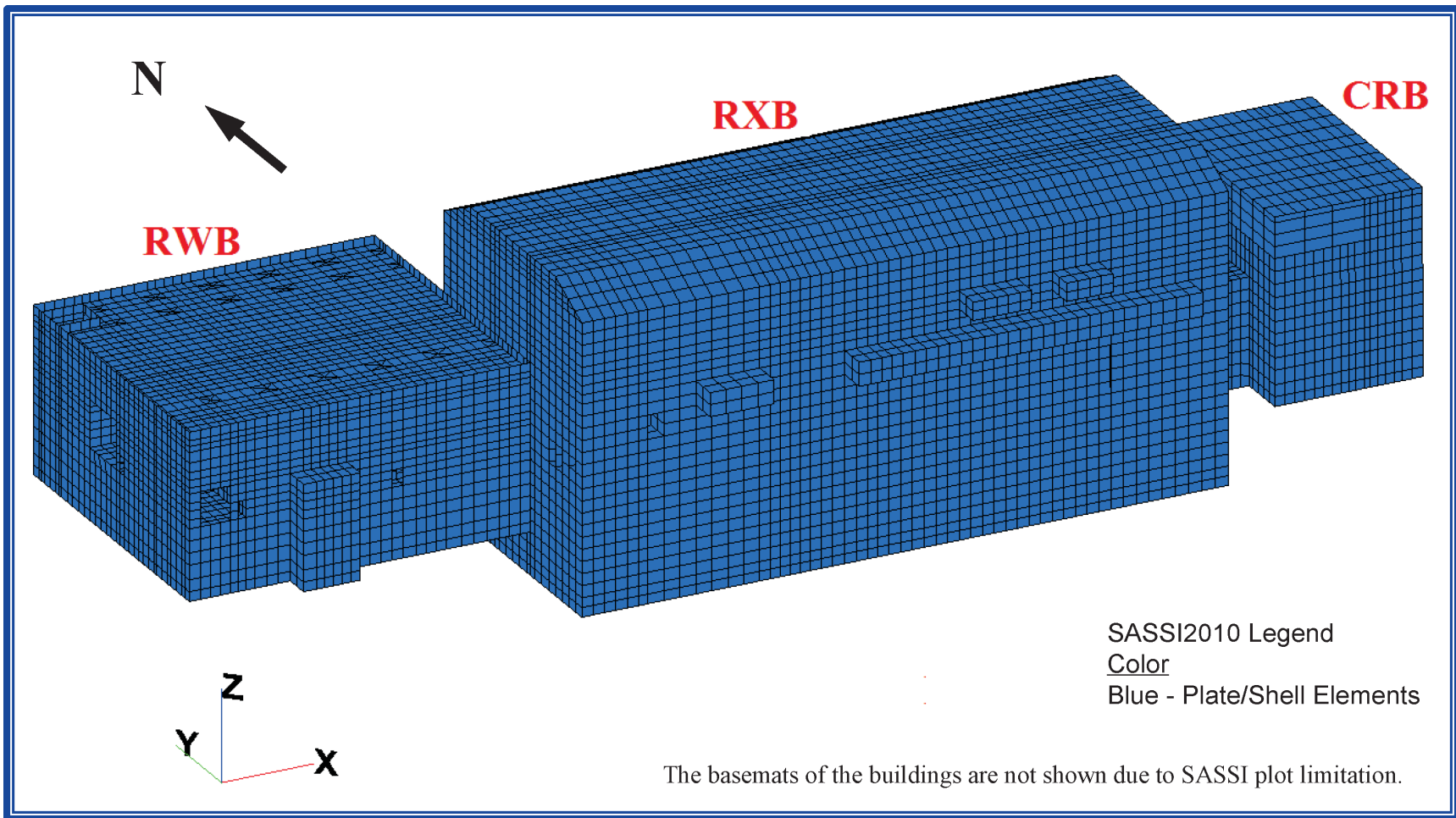


Figure 3.7.2-70: SASSI2010 Triple Building Model Showing South Side of Three Buildings (Looking Northwest)

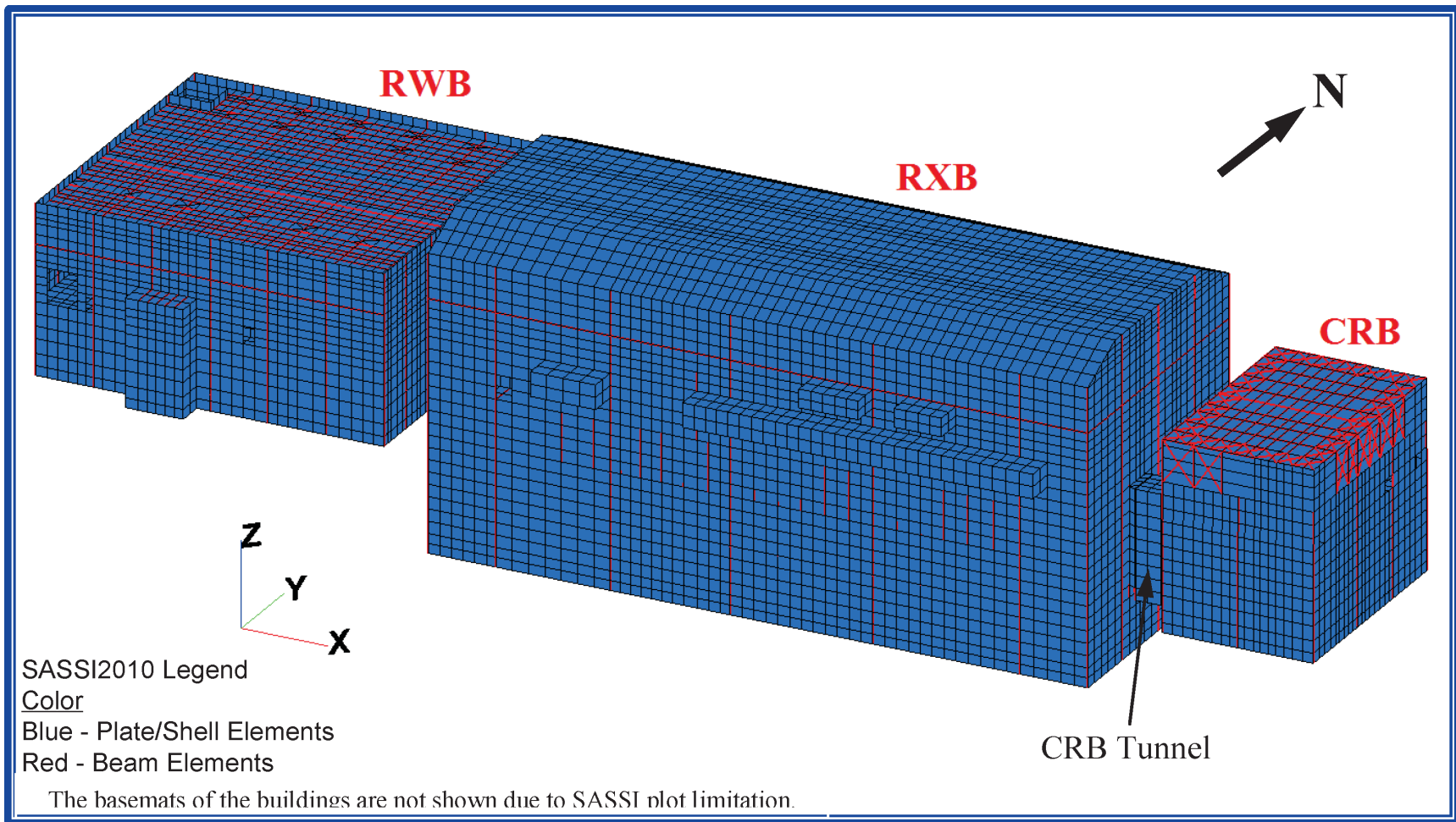




Figure 3.7.2-71: SASSI2010 Triple Building Model Showing North Side of Three Buildings (Looking Southwest)

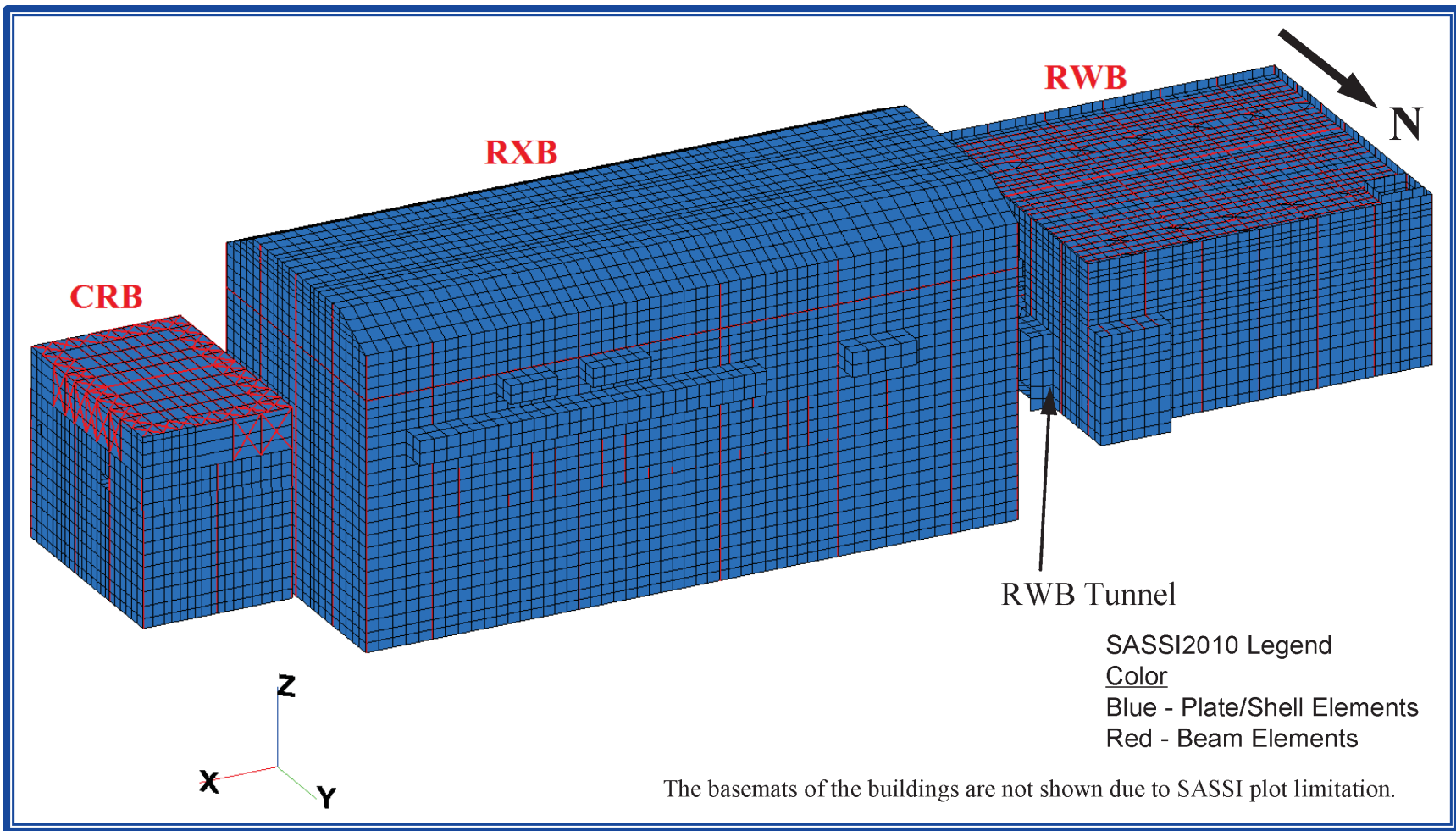


Figure 3.7.2-72: Beam Elements of SASSI2010 Triple Building Model

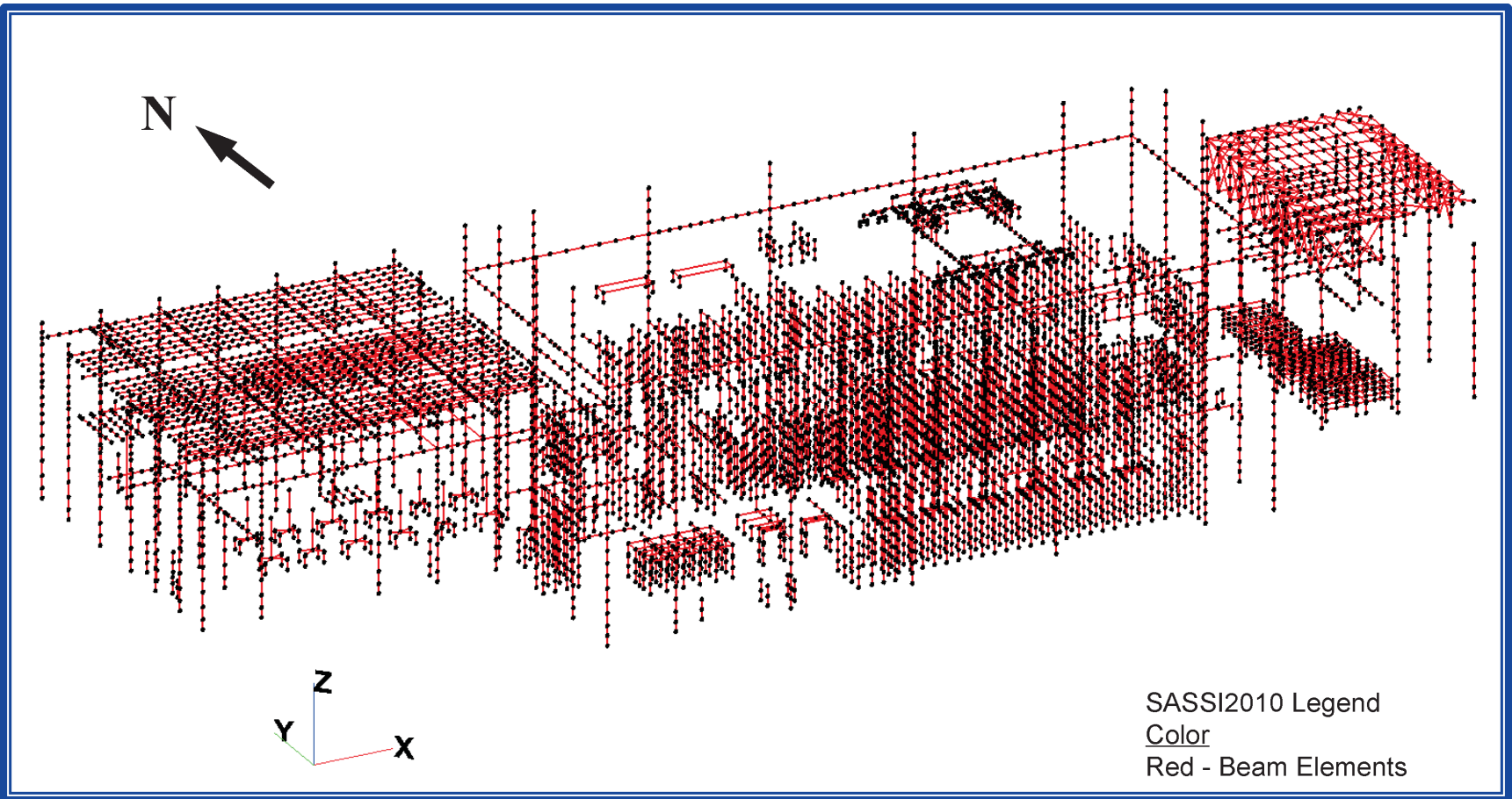


Figure 3.7.2-73: Excavated Soil Solid Elements of the SASSI2010 Triple Building Model

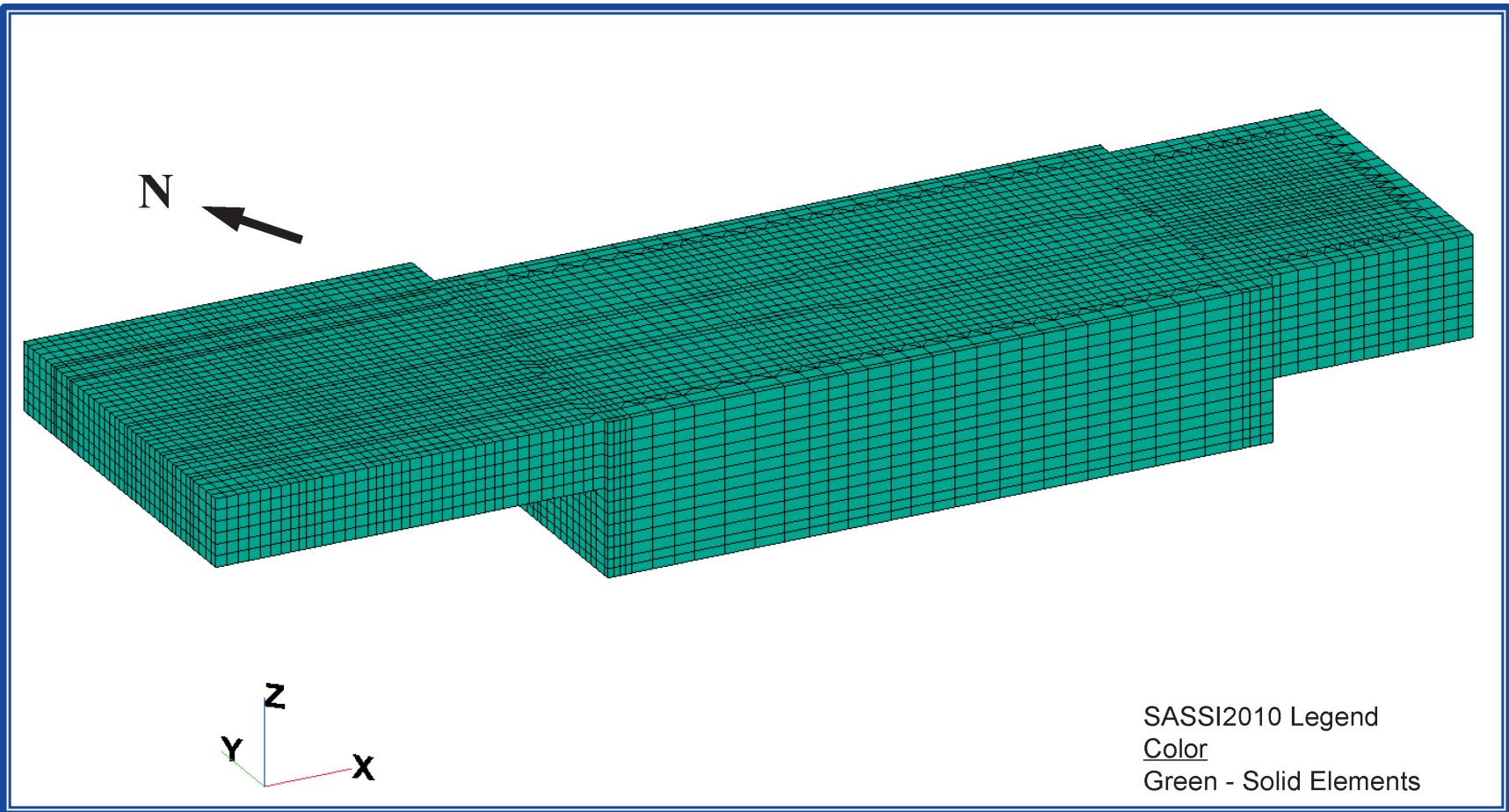




Figure 3.7.2-74: Backfill Soil Solid Elements of the SASSI2010 Triple Building Model

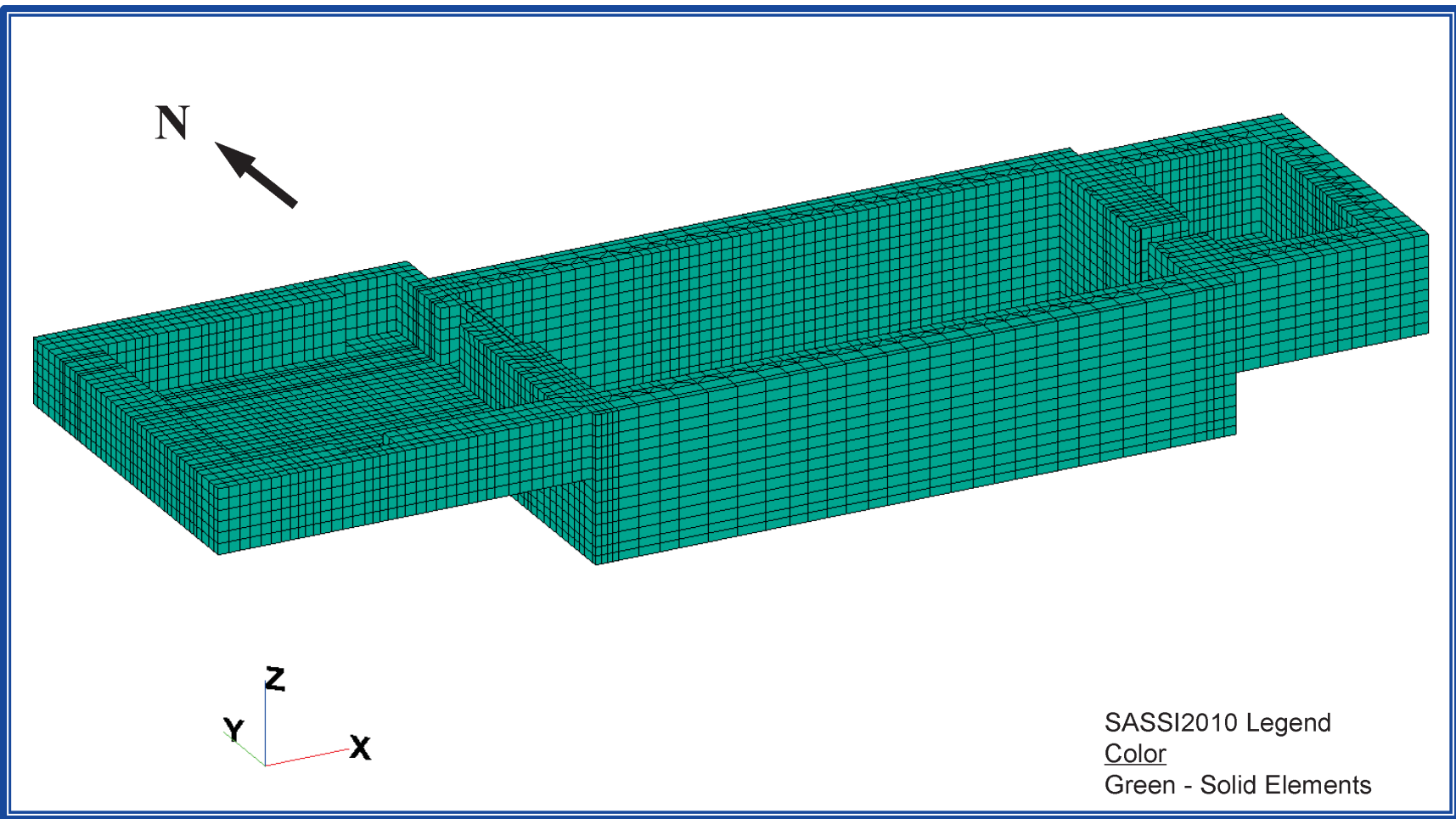


Figure 3.7.2-75: Rigid Soil Springs between Backfill and Free Field Soils of the SASSI2010 Triple Building Model

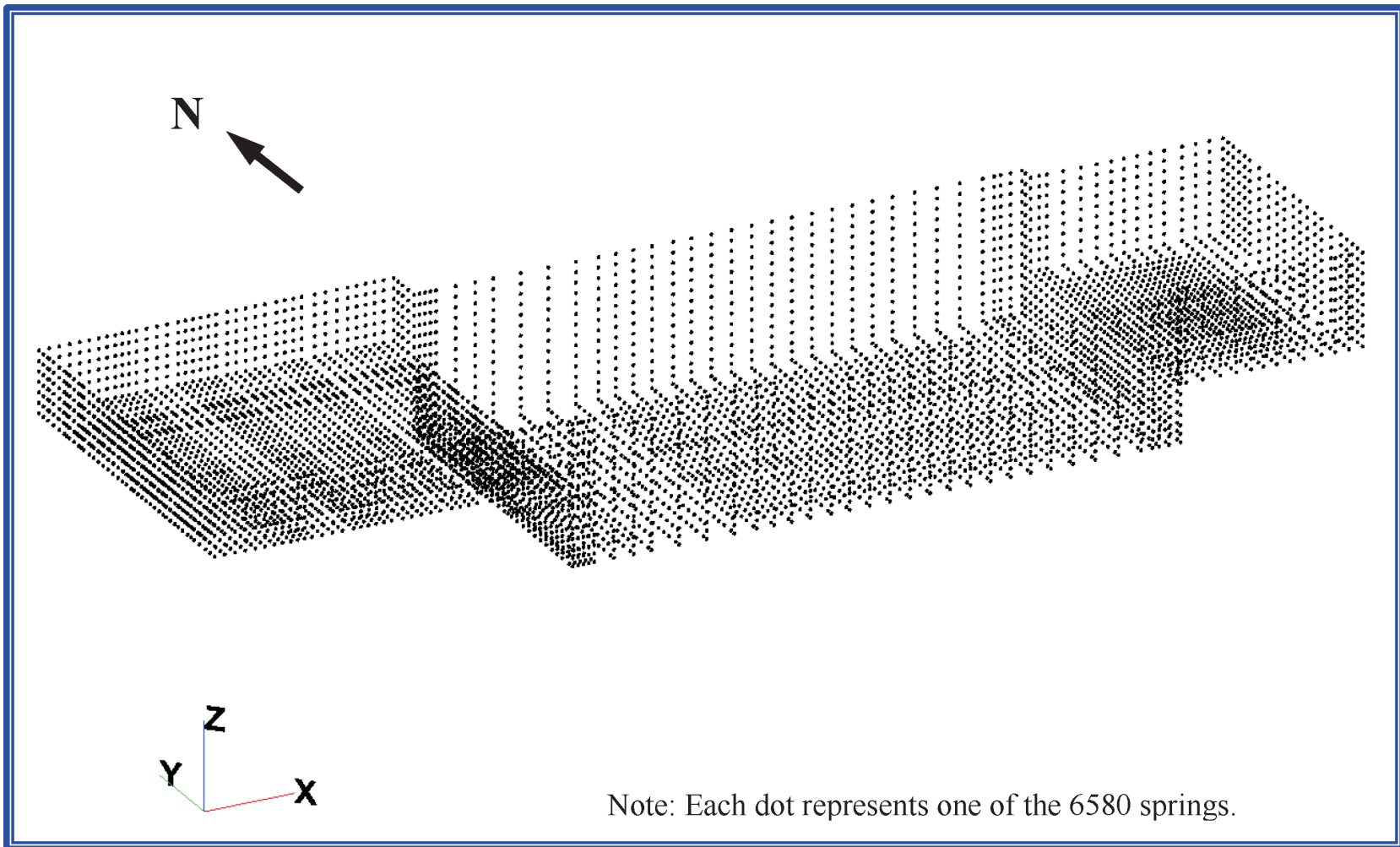
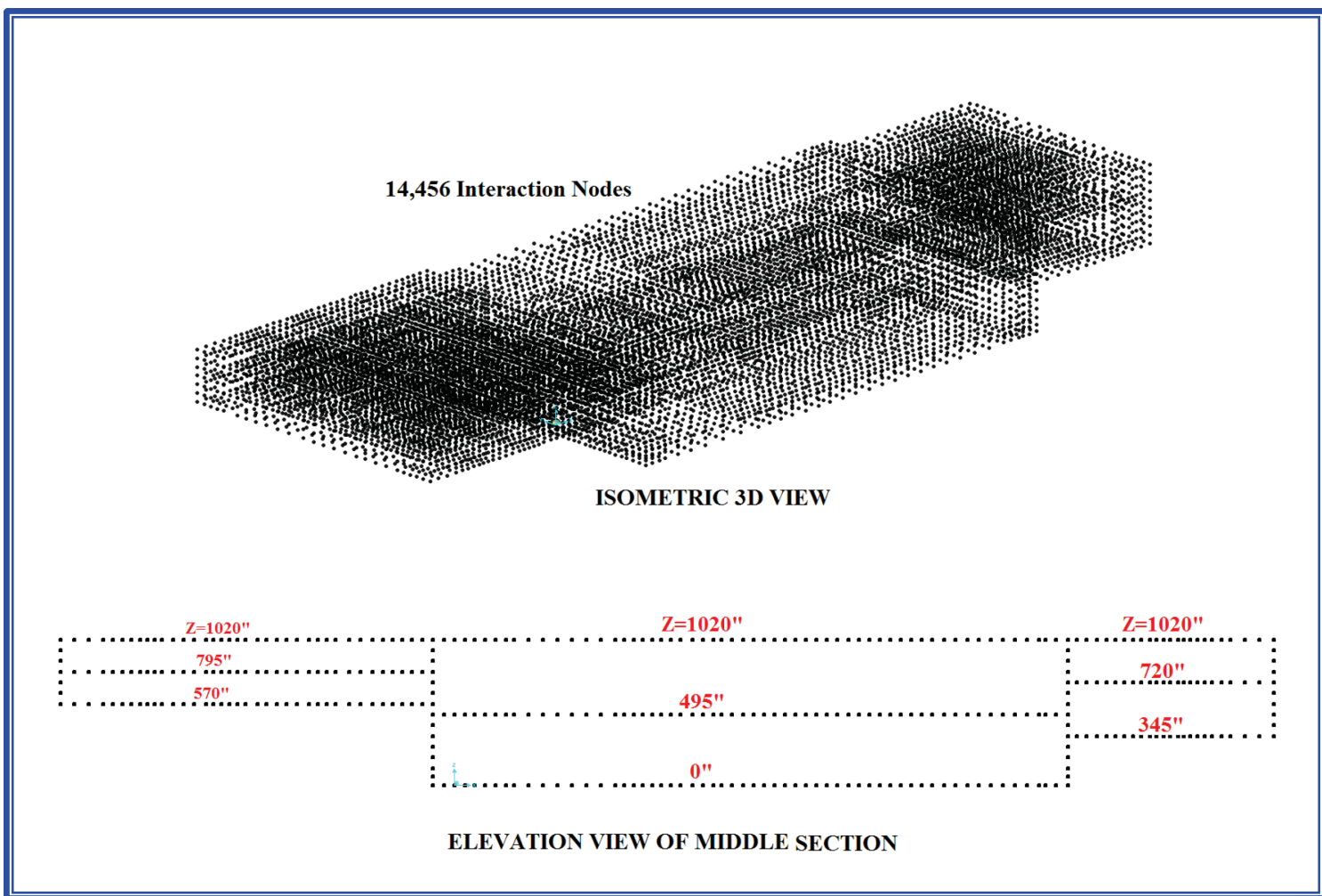
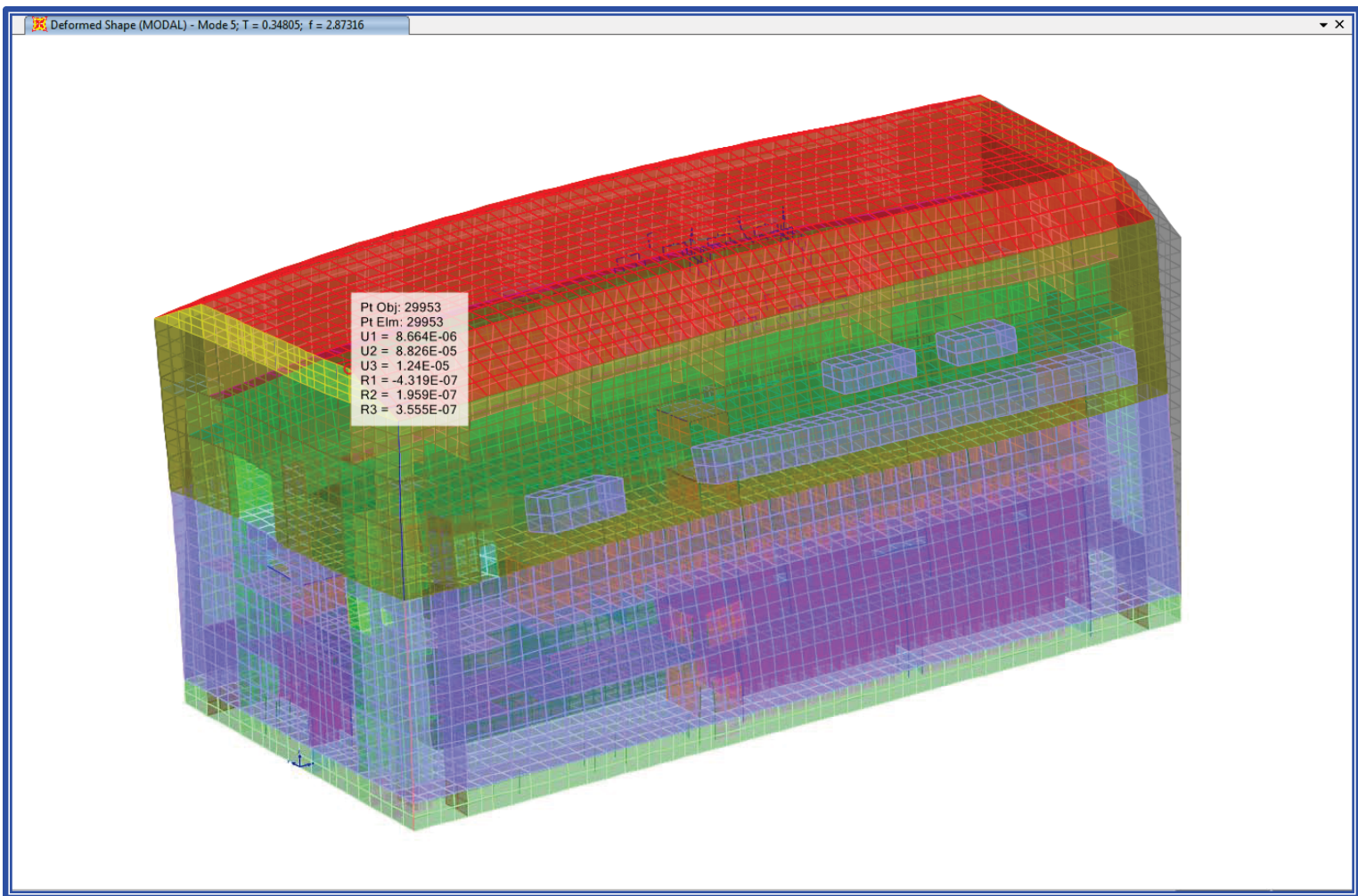
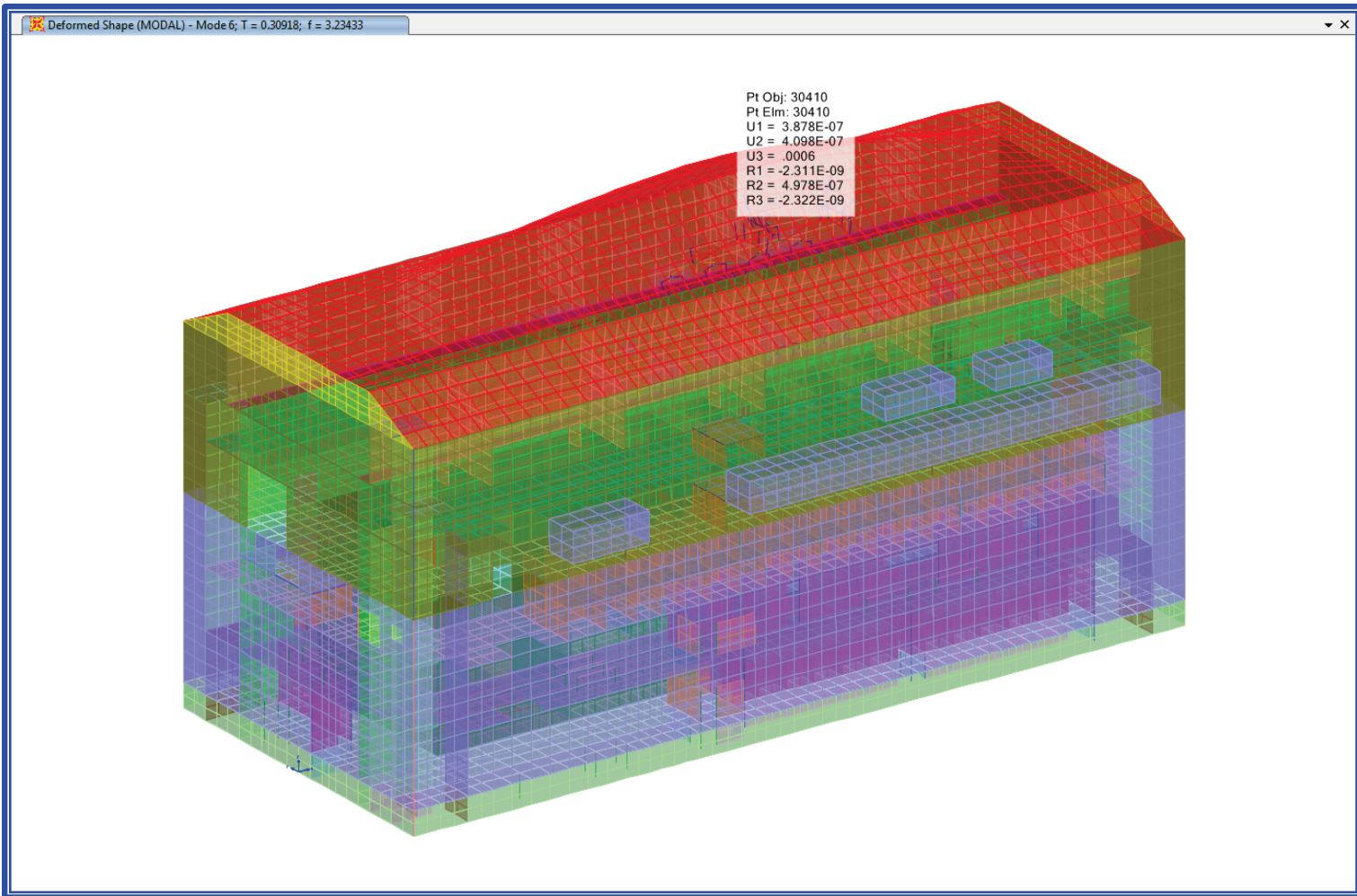


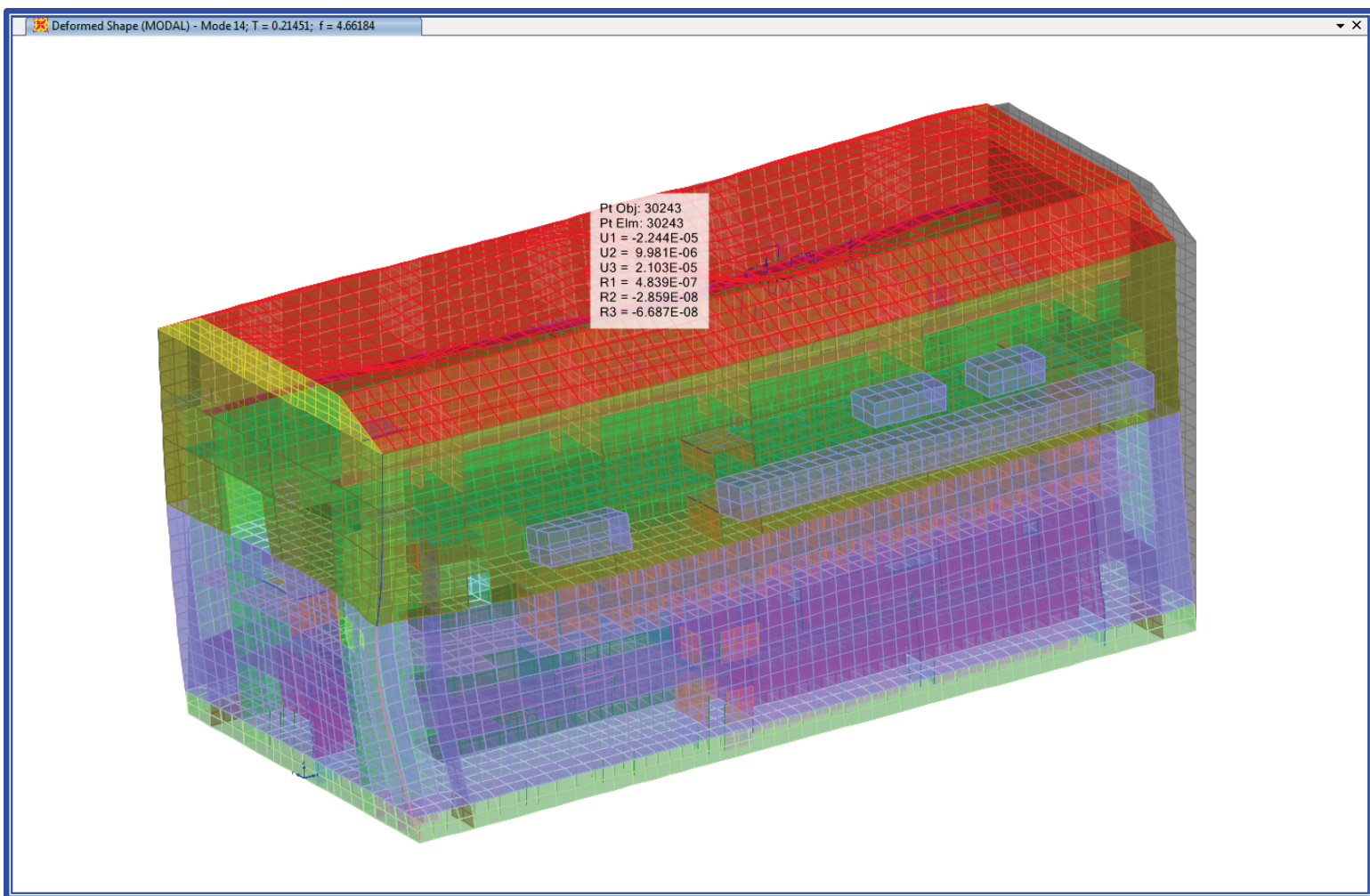
Figure 3.7.2-76: Interaction Nodes for Soil Impedance Calculation

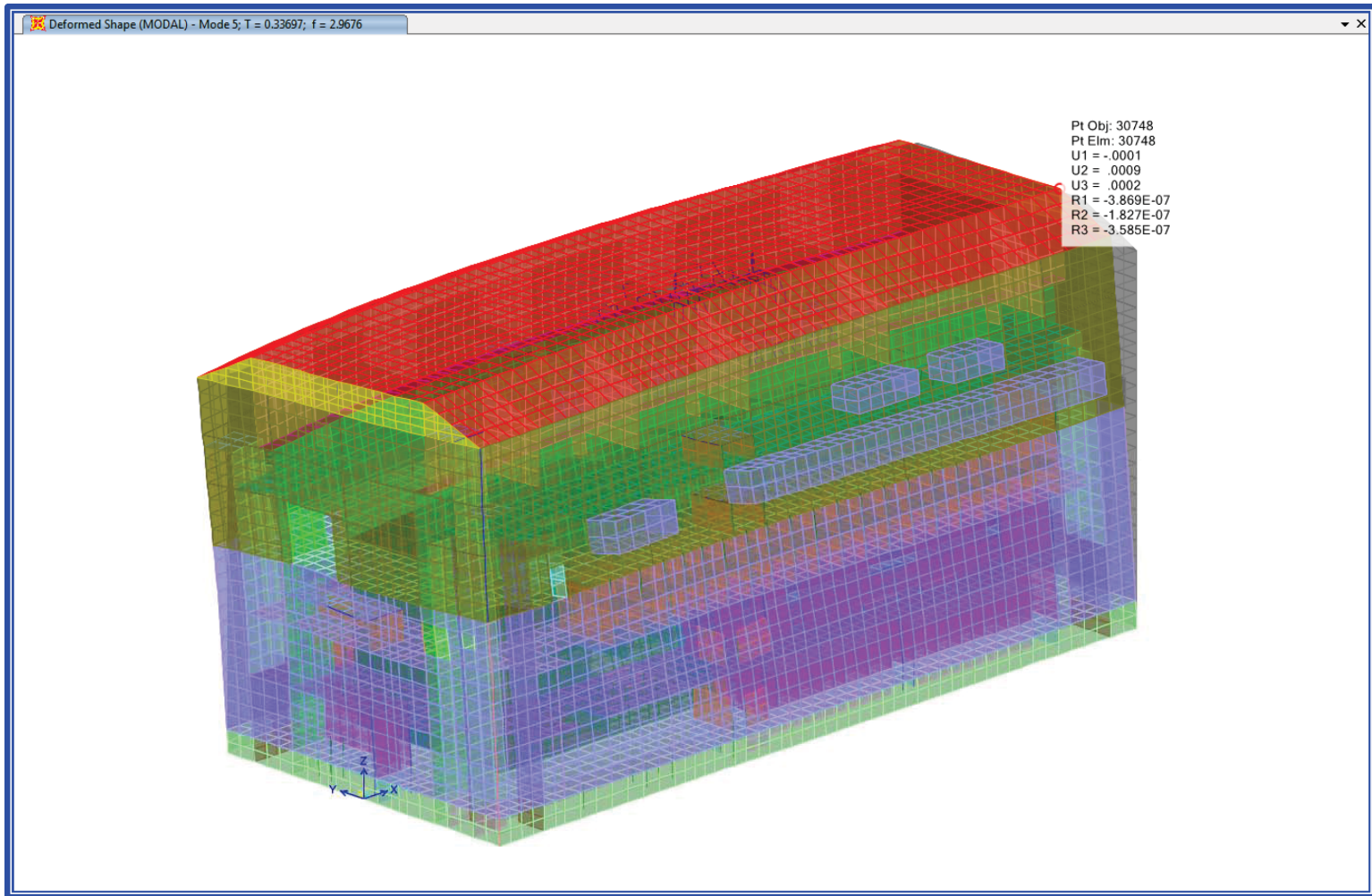


**Figure 3.7.2-77: Reactor Building Cracked Model - Modal Shape - (Mode 5)**



**Figure 3.7.2-78: Reactor Building Cracked Model - Modal Shape - (Mode 6)**

**Figure 3.7.2-79: Reactor Building Cracked Model - Modal Shape - (Mode 14)**

**Figure 3.7.2-80: Reactor Building Uncracked Model - Modal Shape - (Mode 5)**



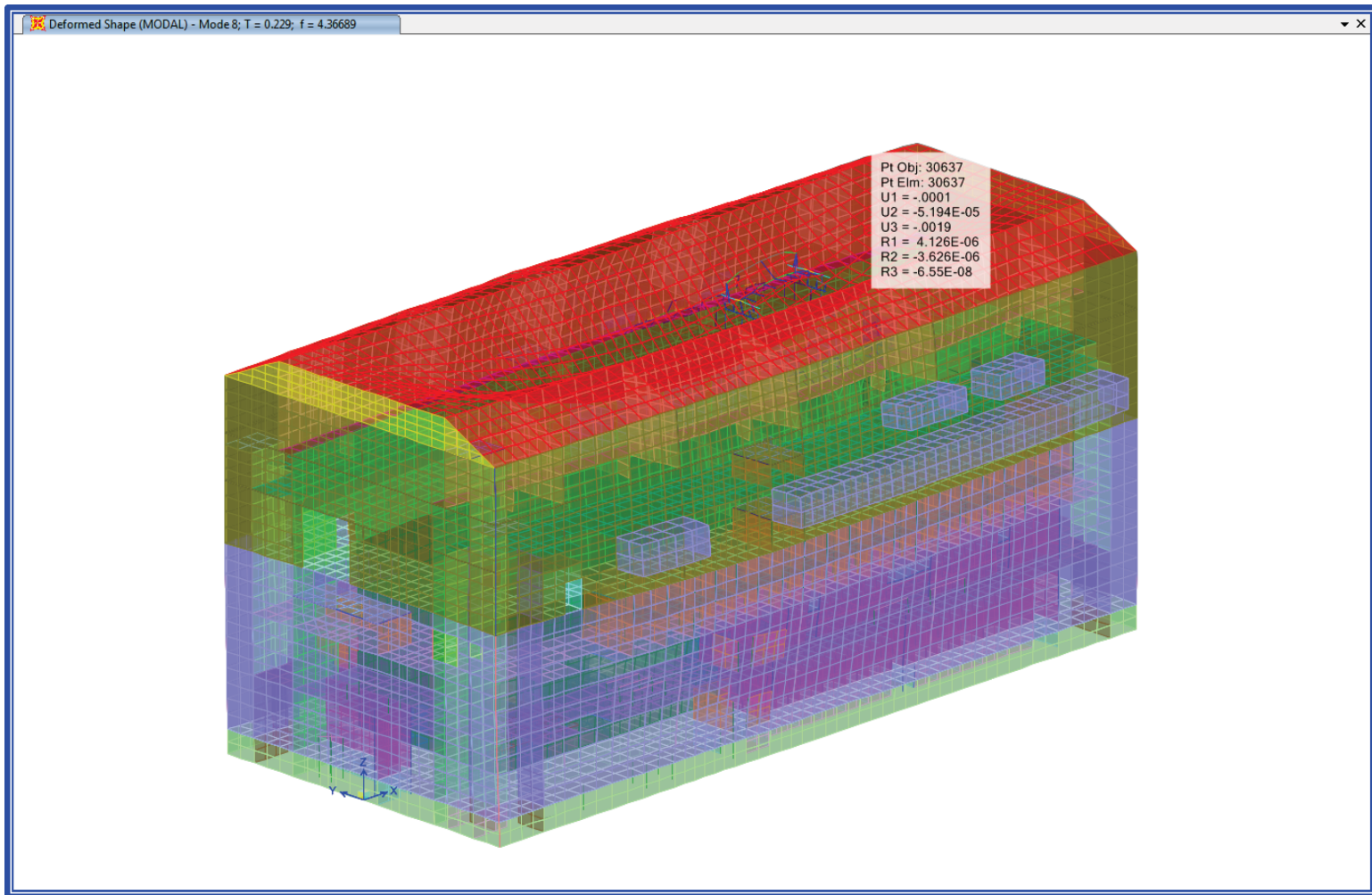
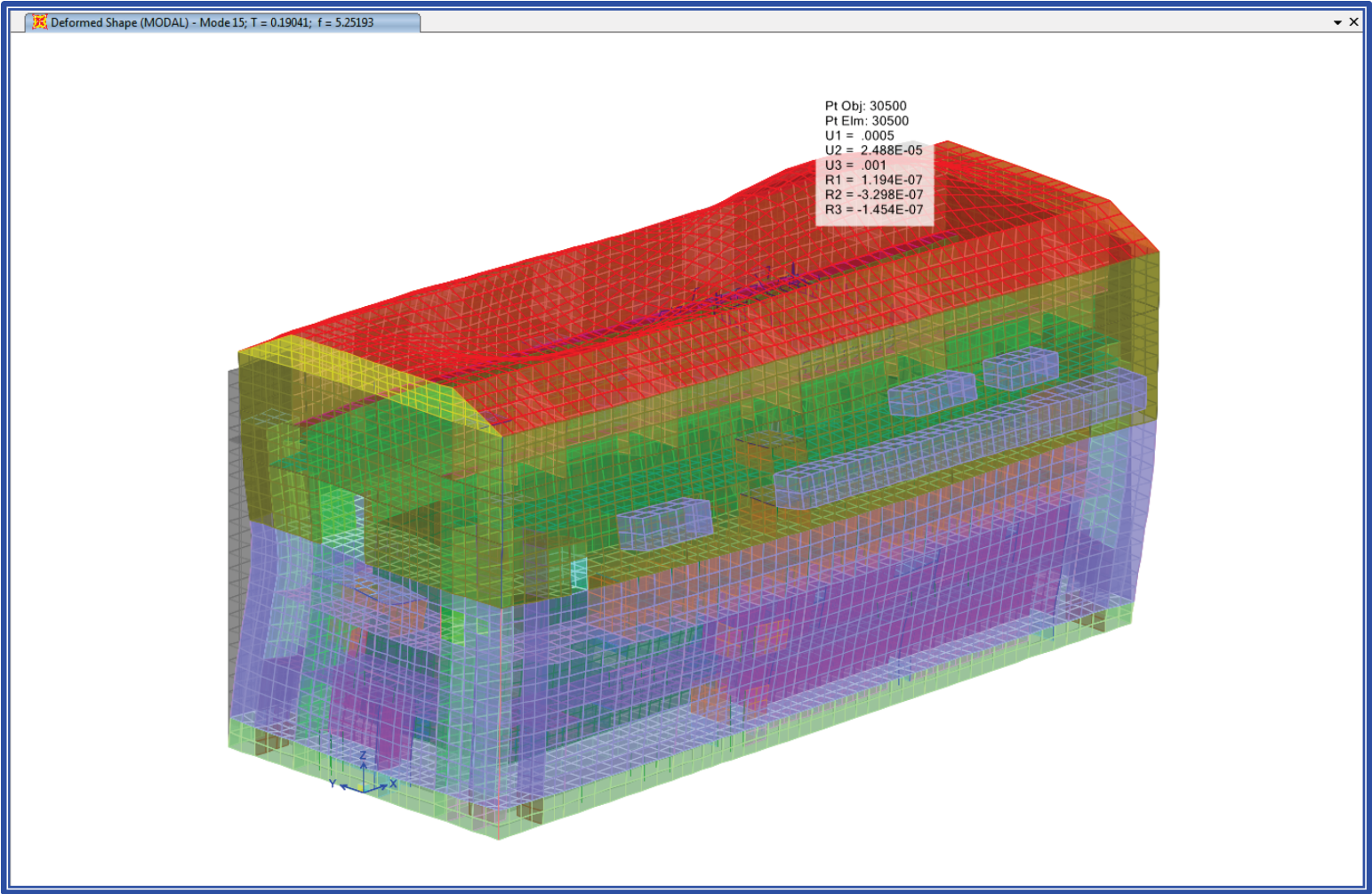
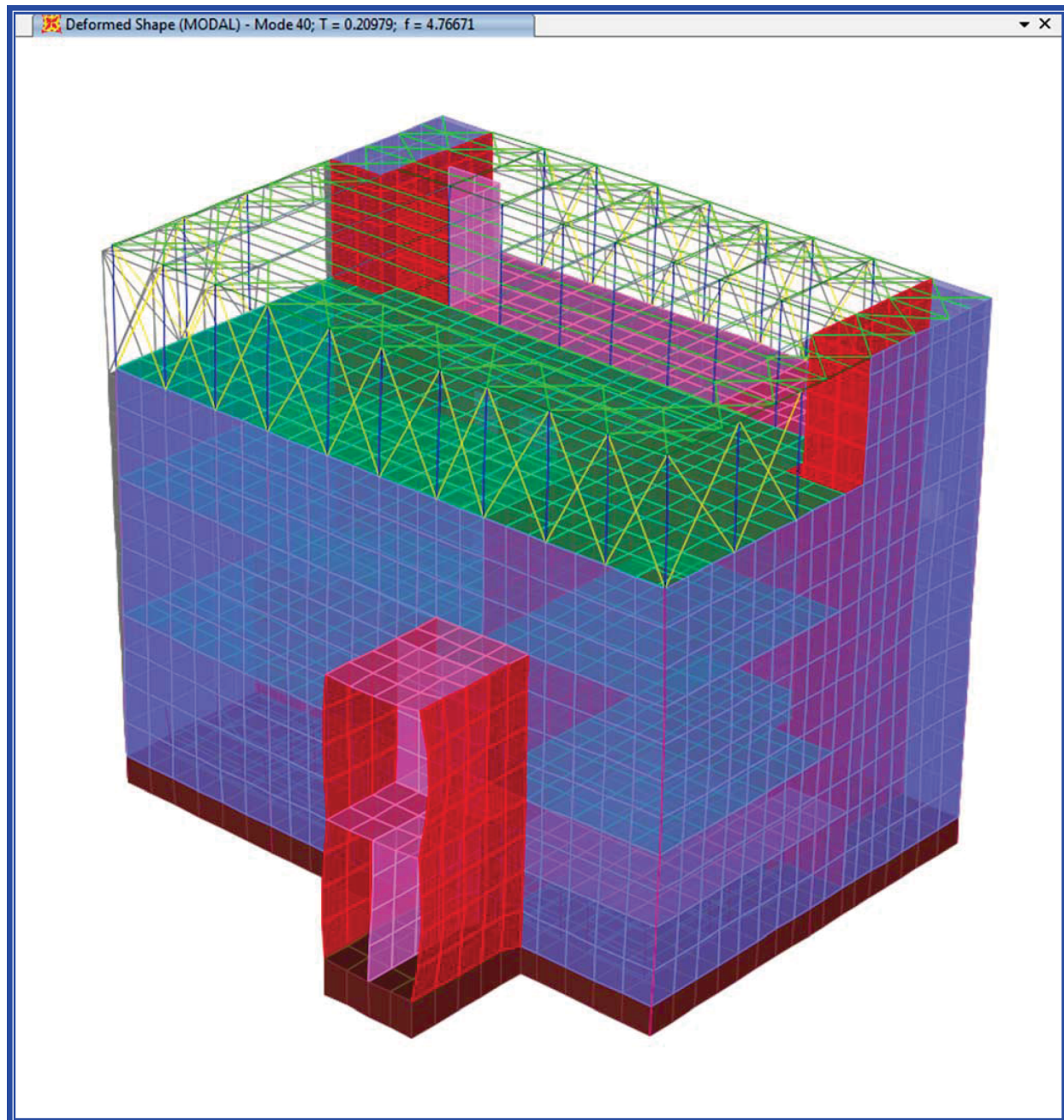
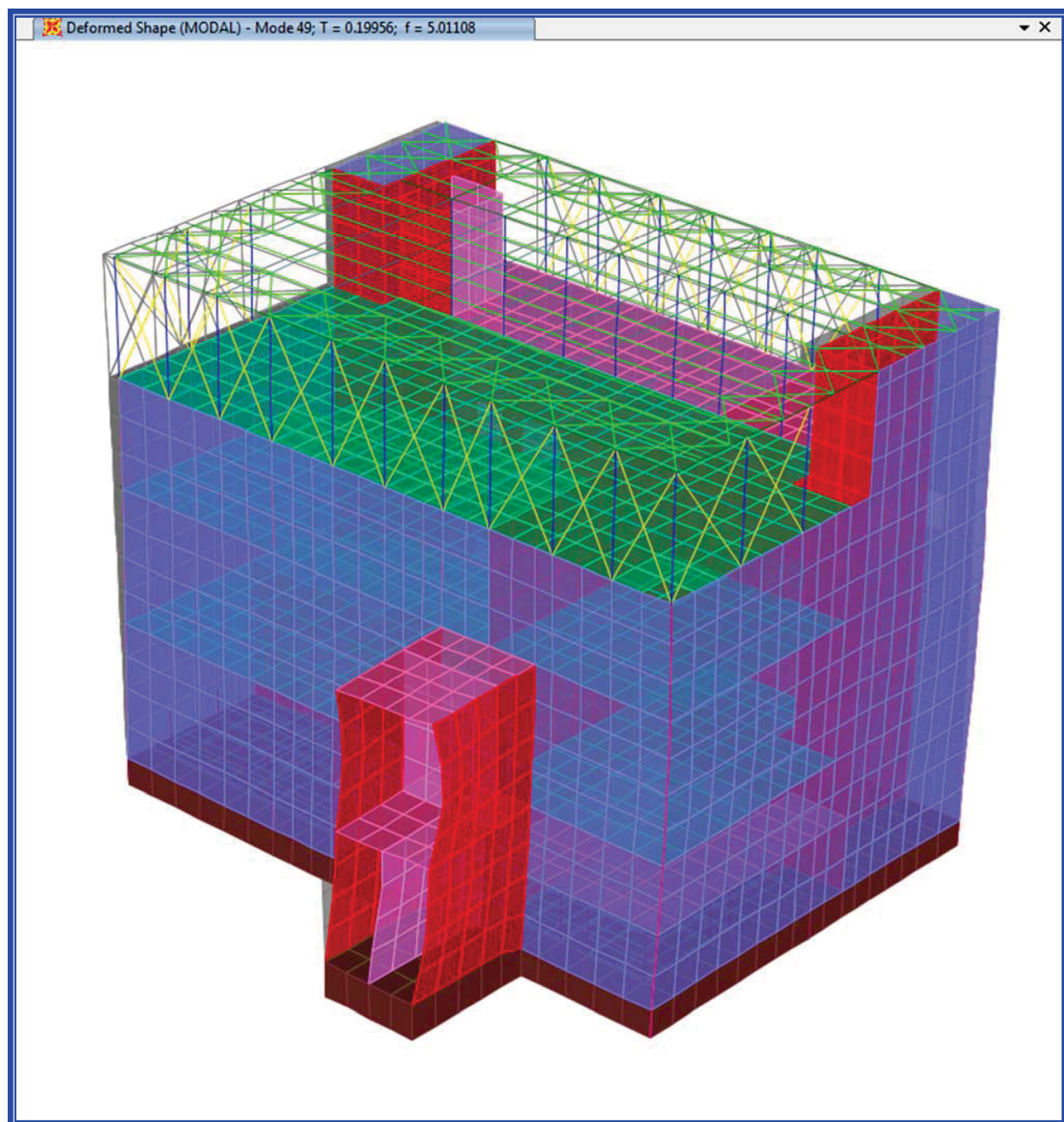
**Figure 3.7.2-81: Reactor Building Uncracked Model - Modal Shape - (Mode 8)**



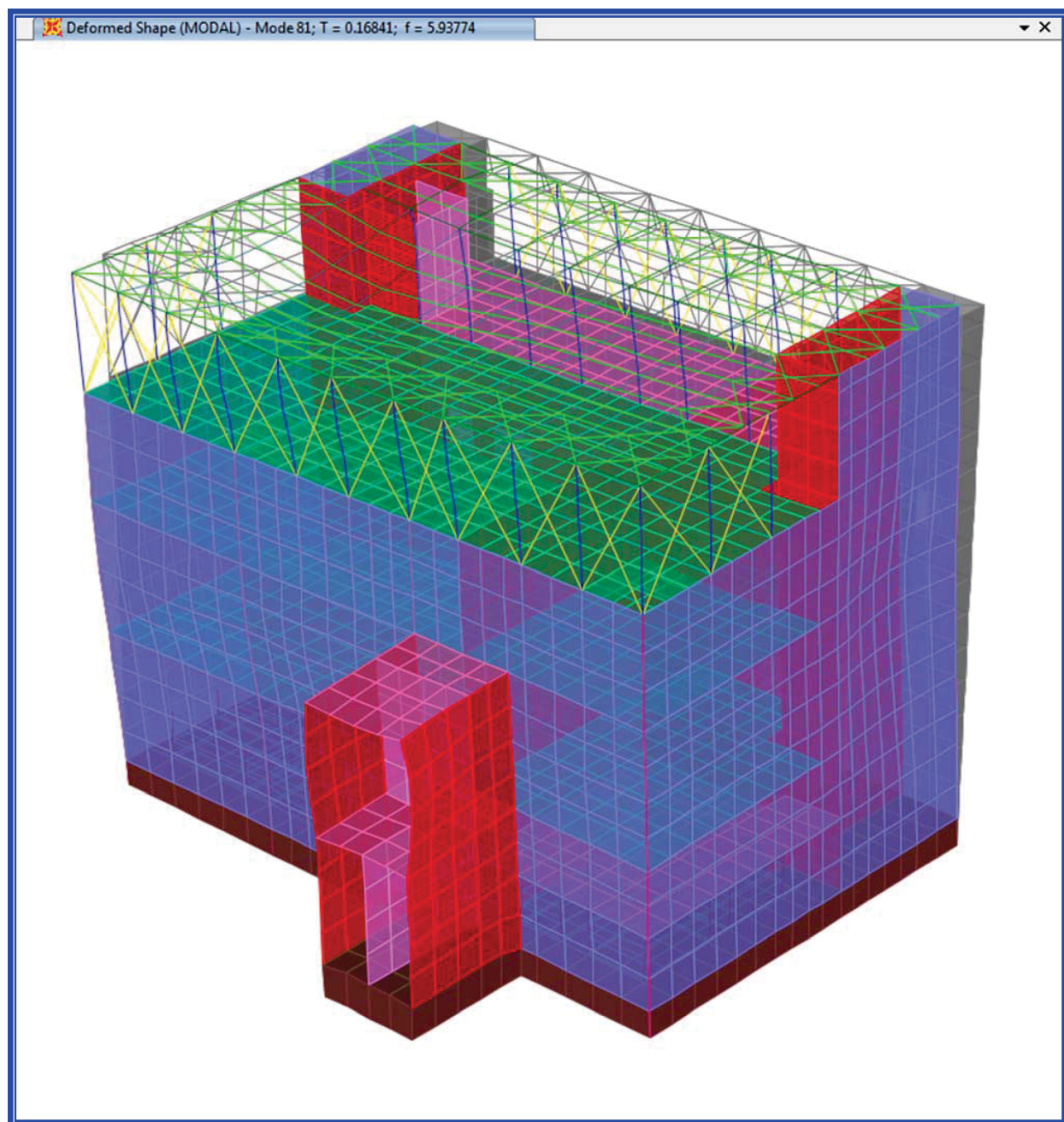
Figure 3.7.2-82: Reactor Building Uncracked Model - Modal Shape - (Mode 15)

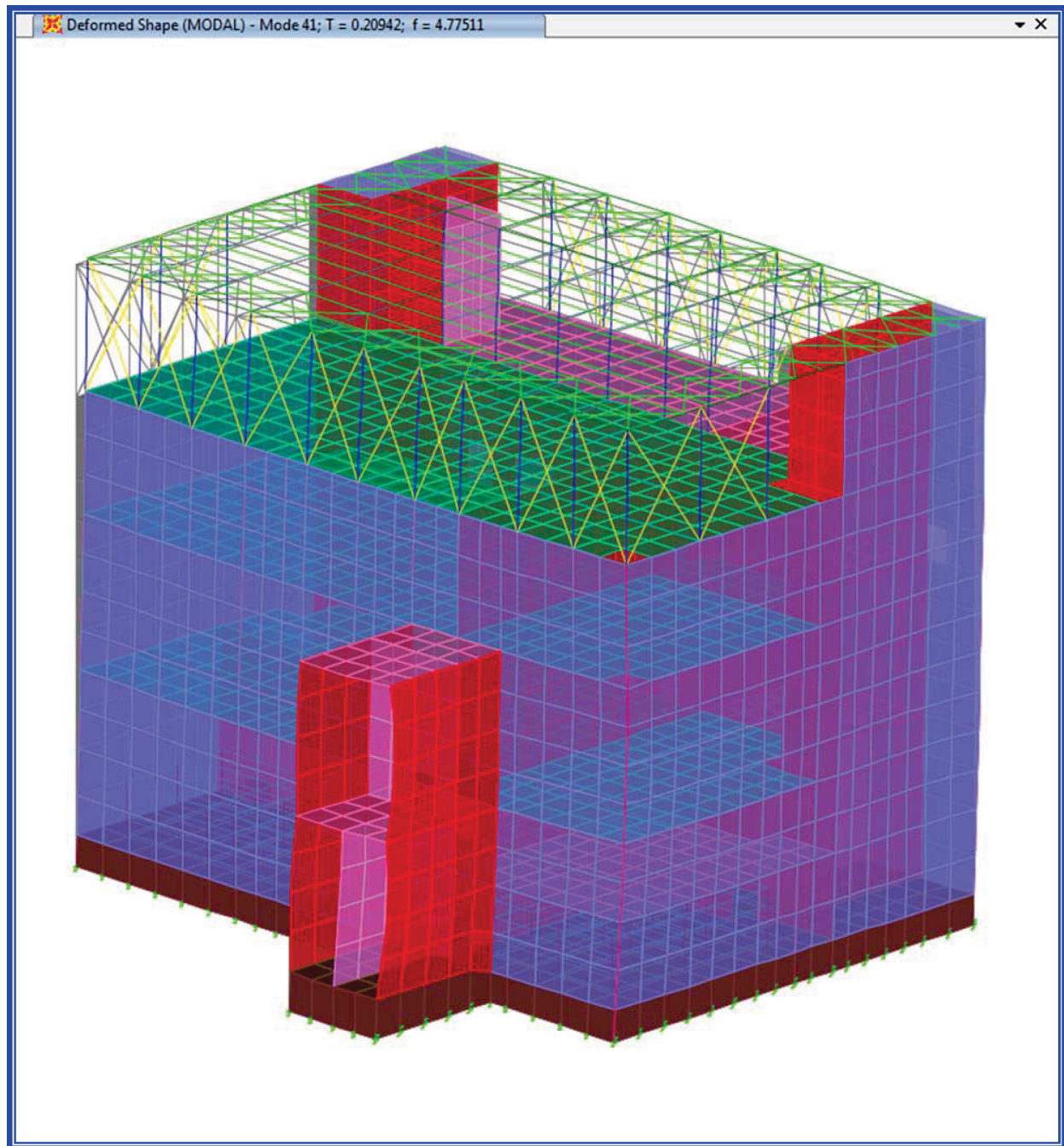


**Figure 3.7.2-83: Control Building Cracked Model - Modal Shape - (Mode 40)**

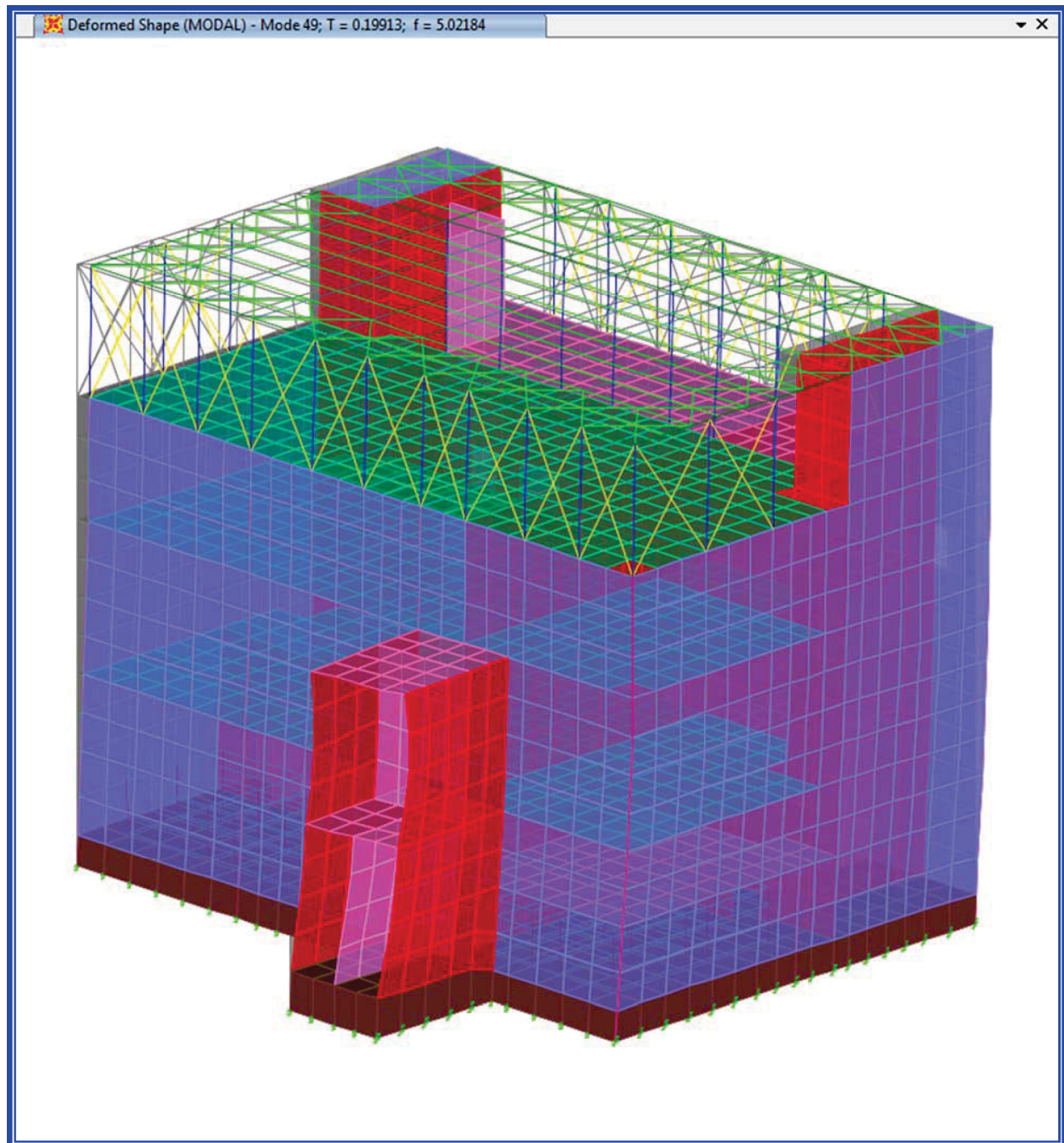
**Figure 3.7.2-84: Control Building Cracked Model - Modal Shape - (Mode 49)**



**Figure 3.7.2-85: Control Building Cracked Model - Modal Shape - (Mode 81)**

**Figure 3.7.2-86: Control Building Uncracked Model - Modal Shape - (Mode 41)**



**Figure 3.7.2-87: Control Building Uncracked Model - Modal Shape - (Mode 49)**

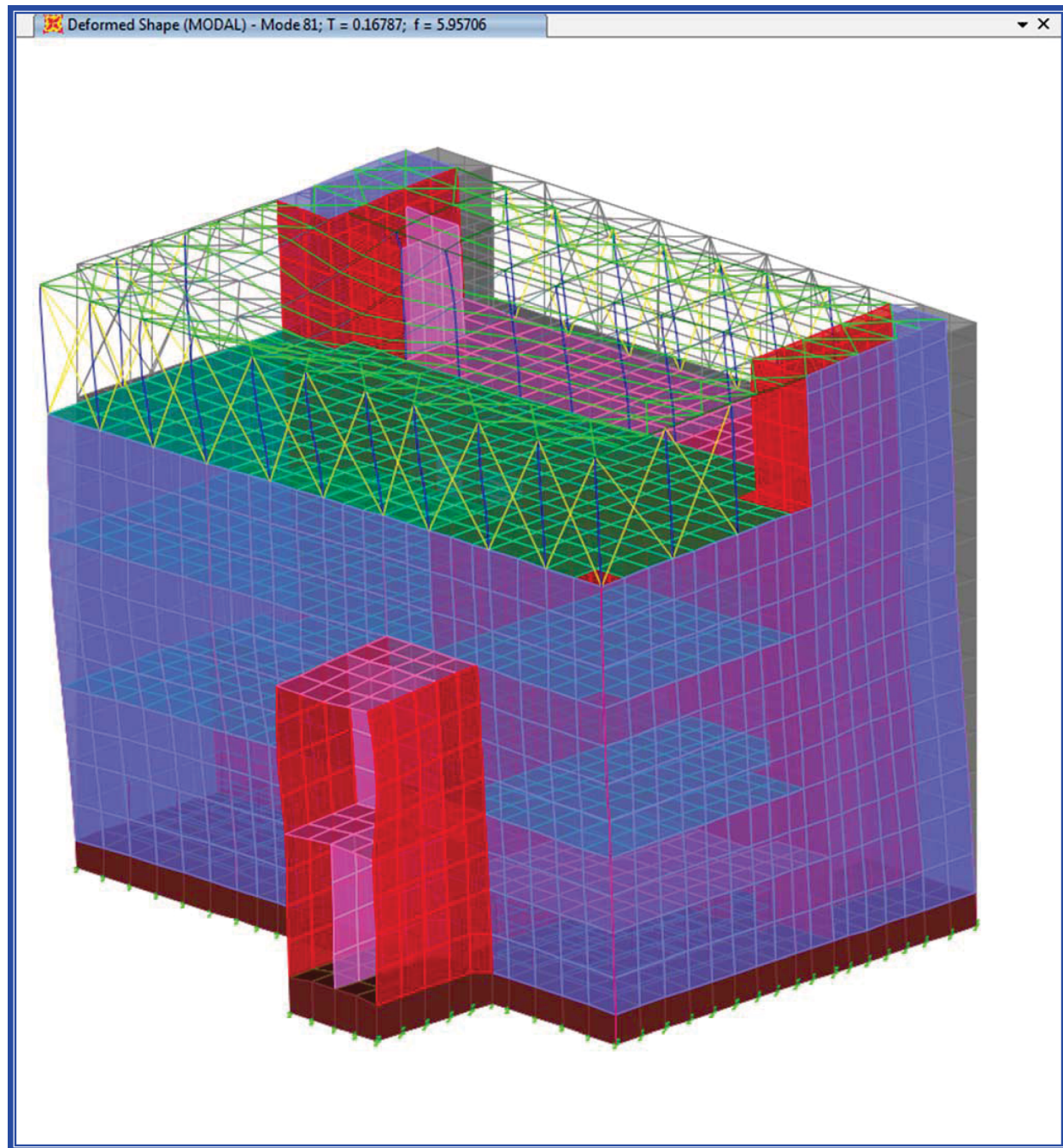
**Figure 3.7.2-88: Control Building Uncracked Model - Modal Shape - (Mode 81)**

Figure 3.7.2-89: Flow of Files among SASSI2010 Modules

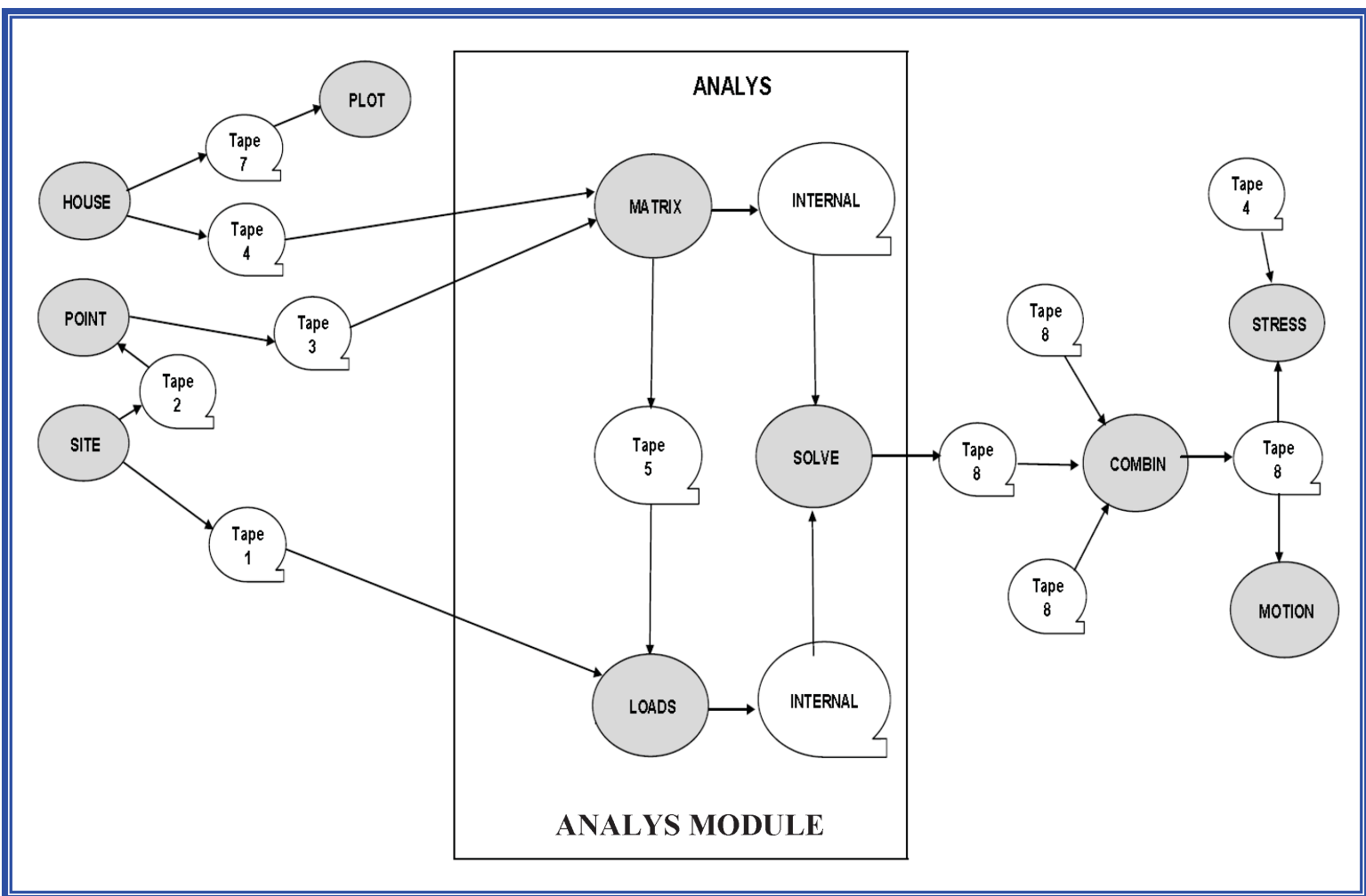




Figure 3.7.2-90: Four I, J, K, and L Nodes and 1 through 5 Output Locations of Thick Shell Element

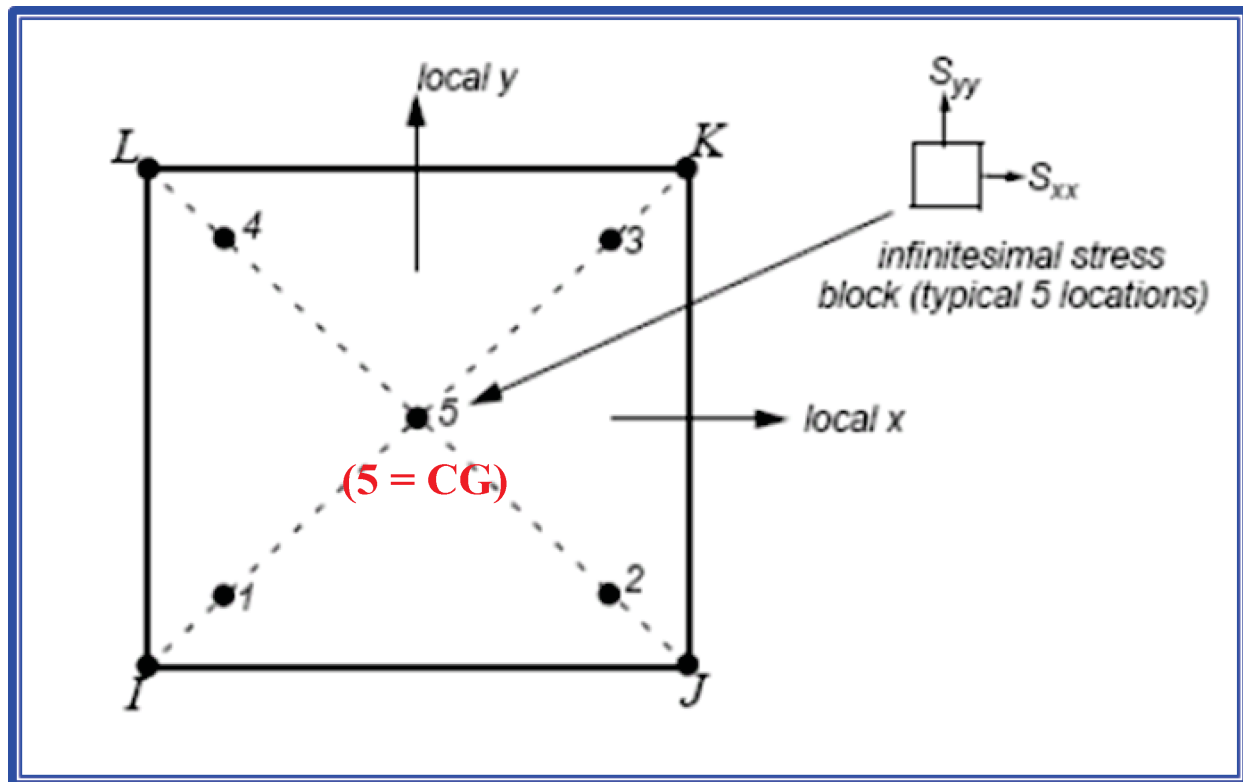


Figure 3.7.2-91: SASSI2010 Shear and Moment Resultants

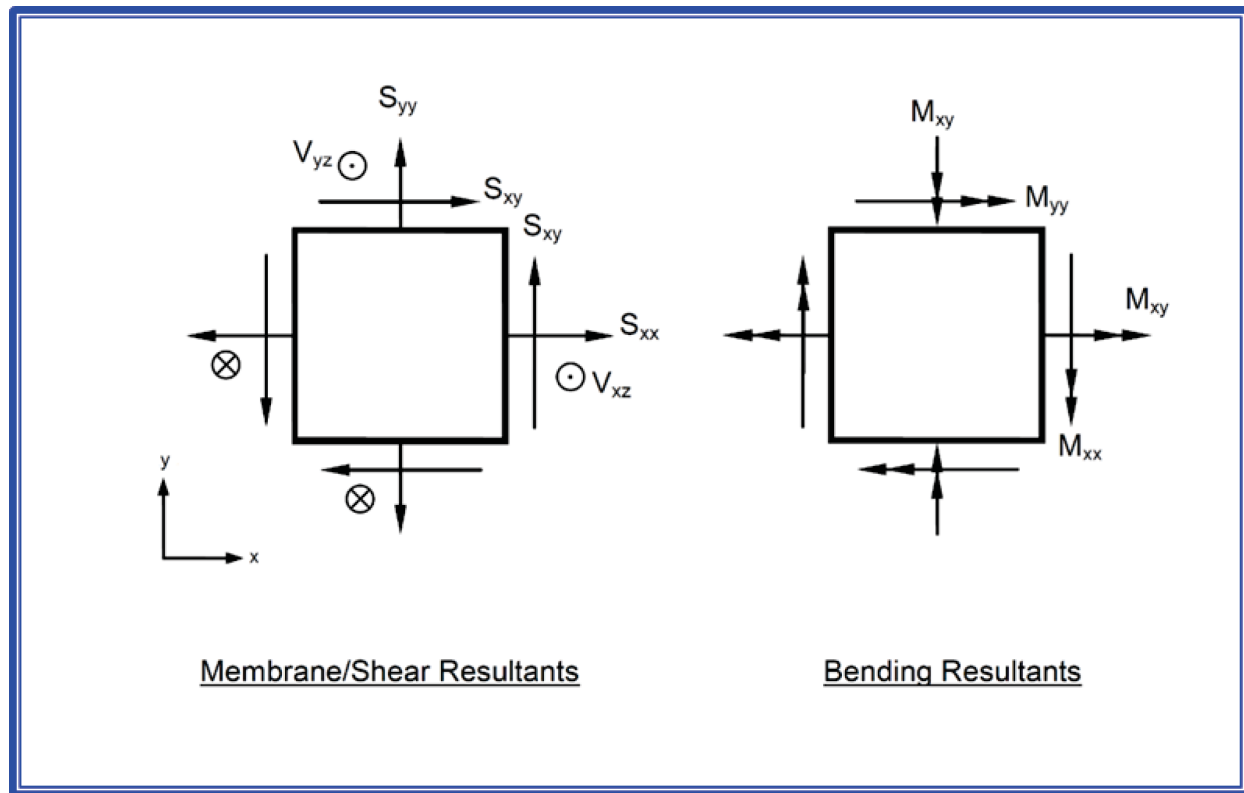


Figure 3.7.2-92: SASSI2010 Beam Element Local Axes for Forces and Moments

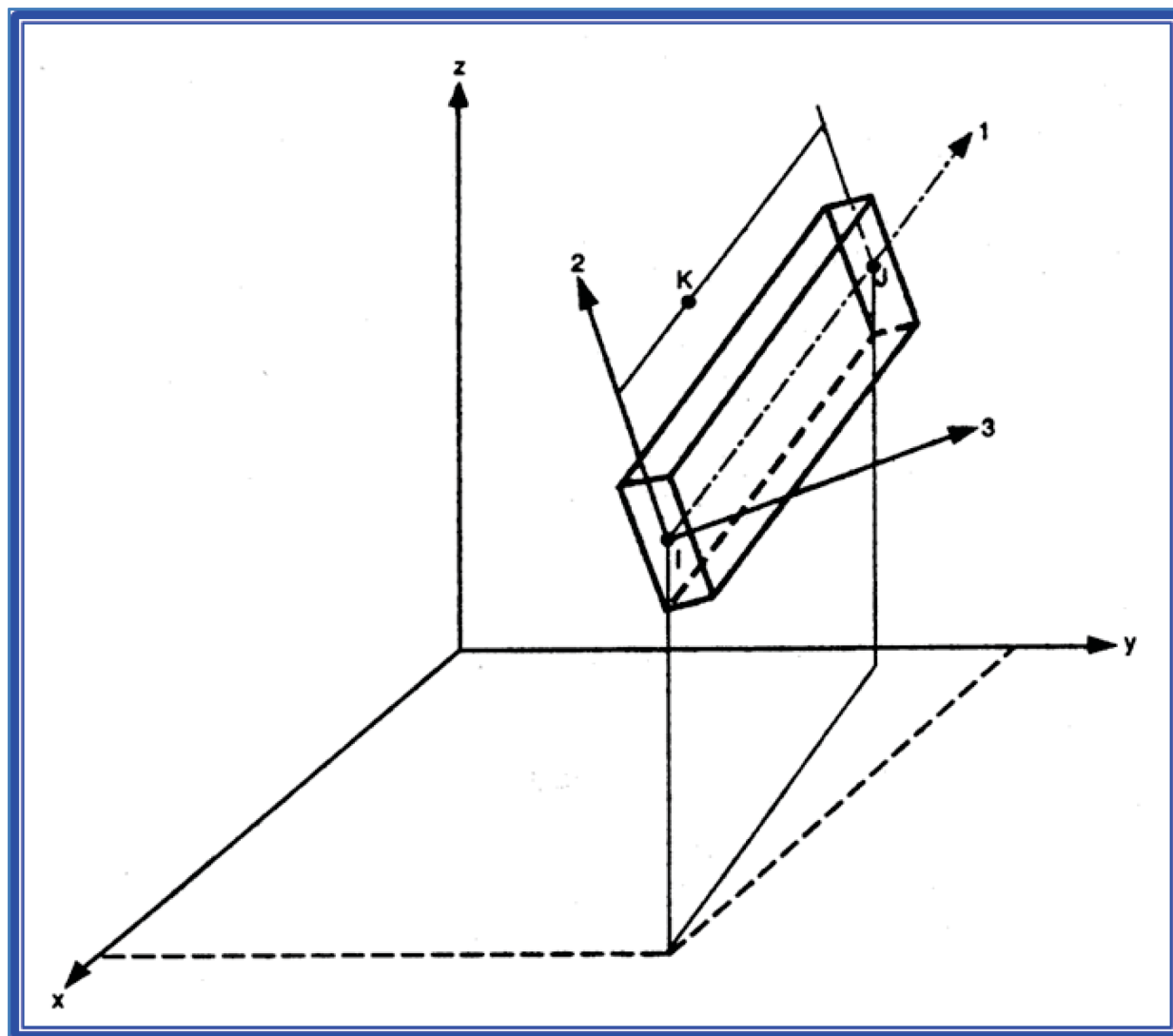


Figure 3.7.2-93: SASSI2010 Global Stresses at Centroid of a Solid Element

